

Original instructions
SIRe Competent
Quick guide

SIRe AC
SIRe FC

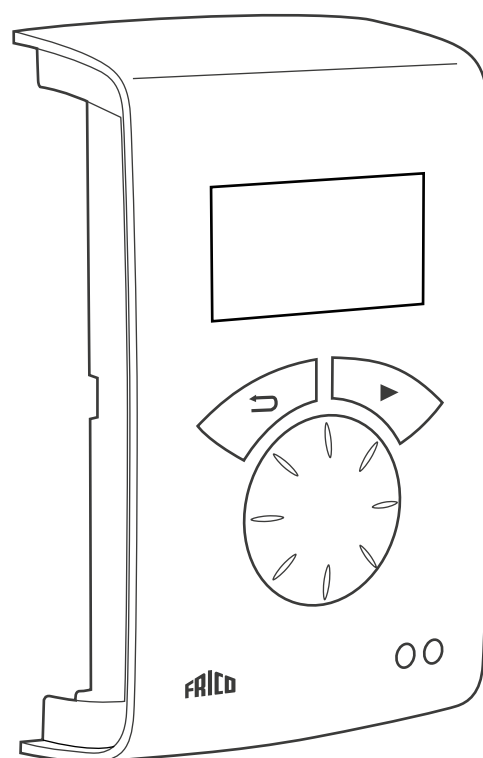

SE ... 18

GB ... 25

DE ... 32

FR ... 39

ES ... 46

IT ... 53

NL ... 60

NO ... 67

PL ... 74

RU ... 81

FI ... 89

Wiring diagram - Competent SIReAC/SIRe FC

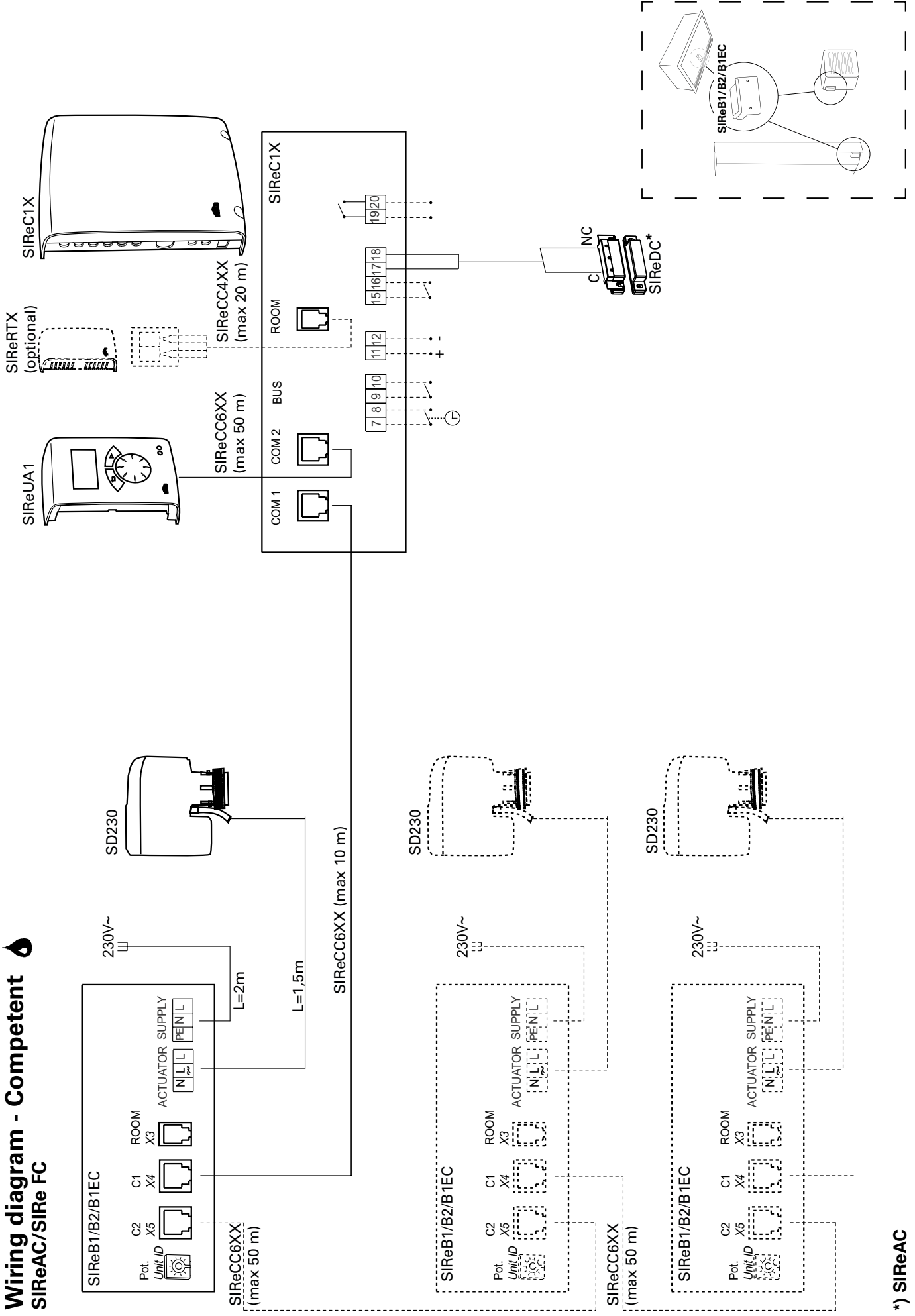

*) SIReAC

Wiring diagram - Competent

SIReAC/SIRe FC

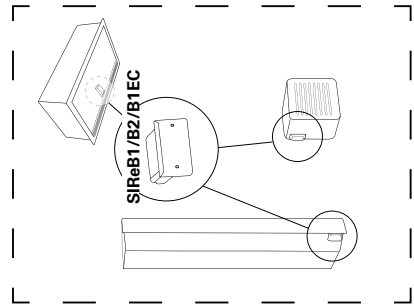
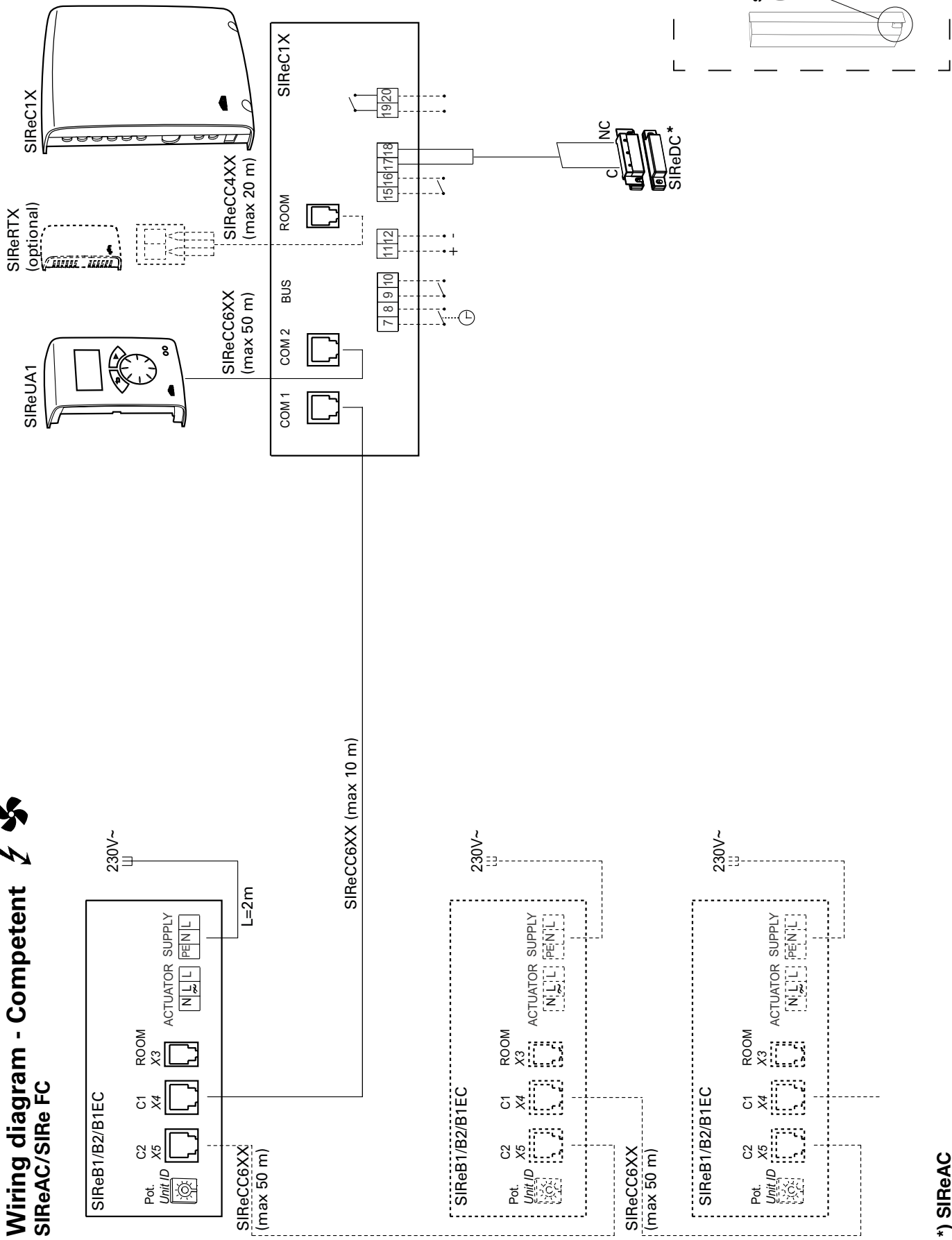

*) SIReAC

1

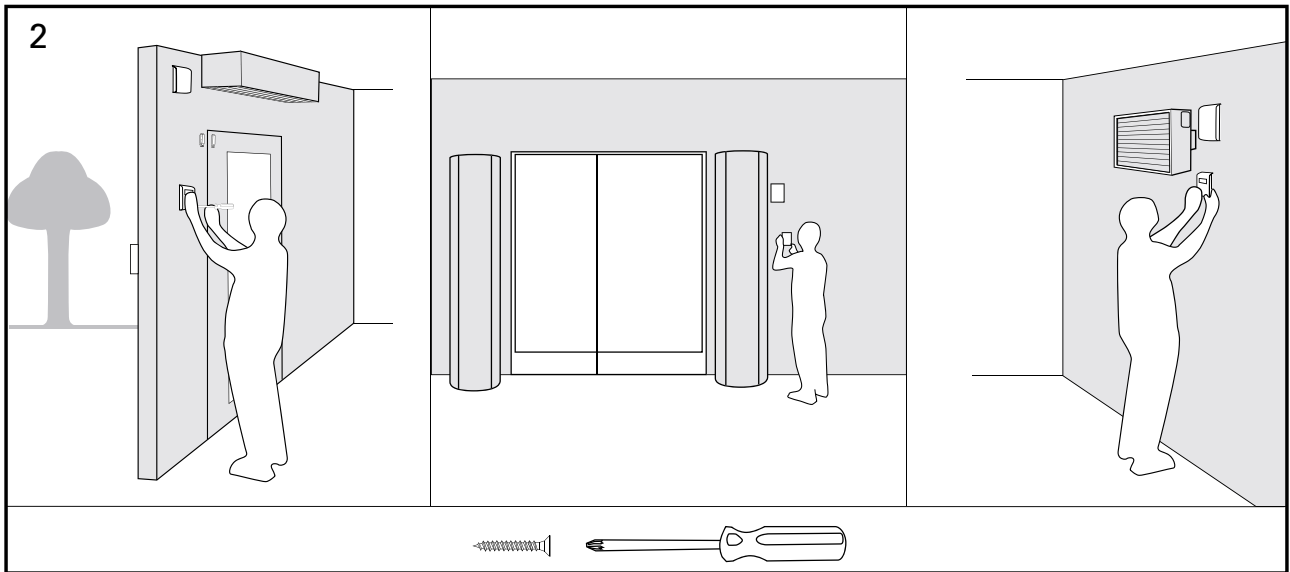
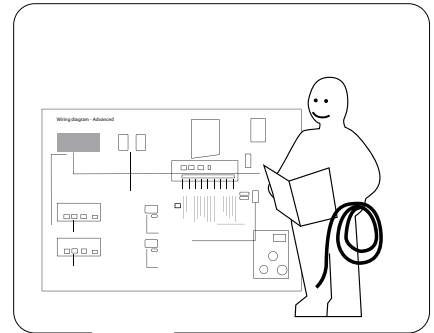
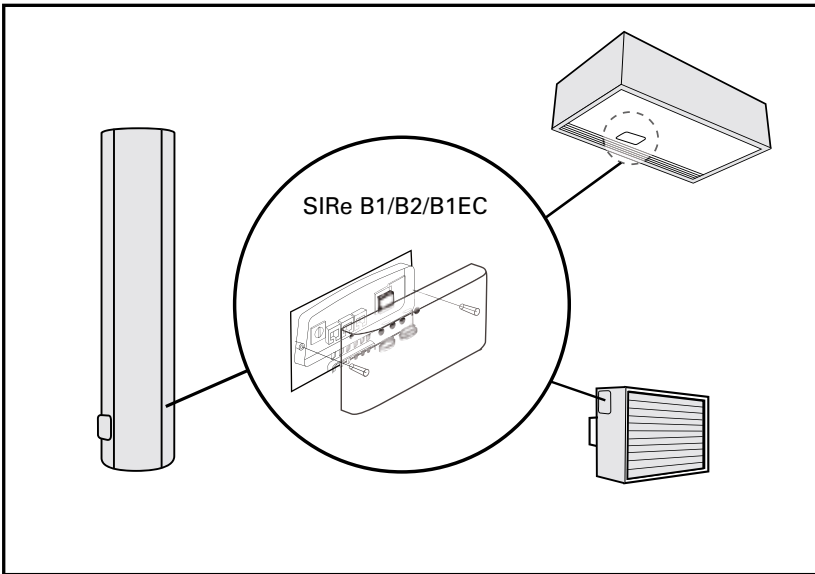
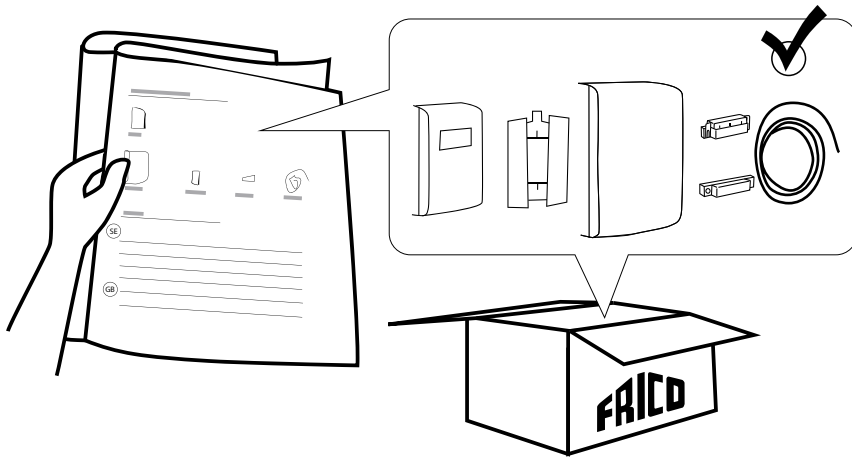

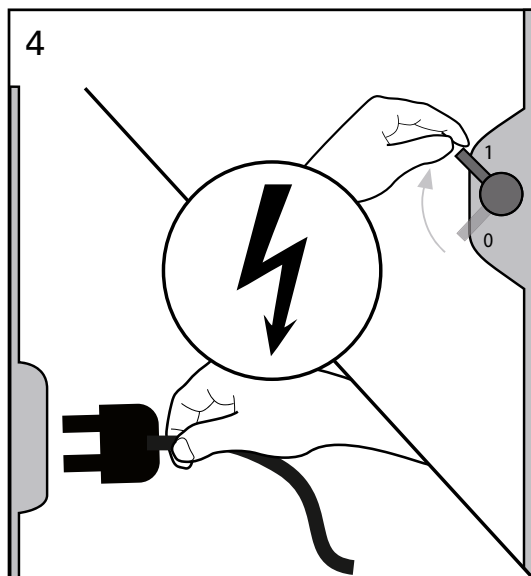
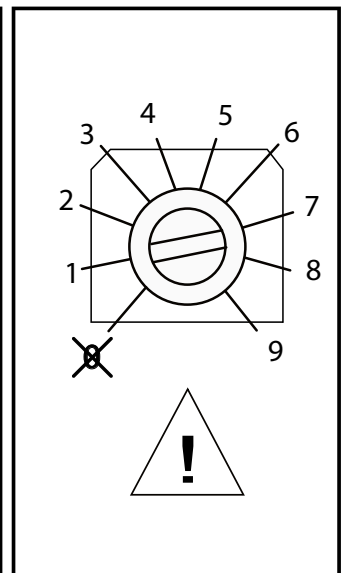
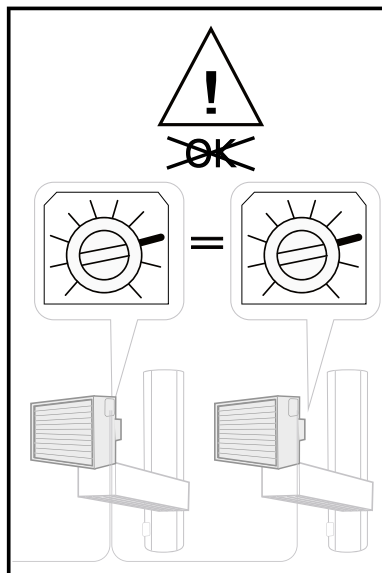
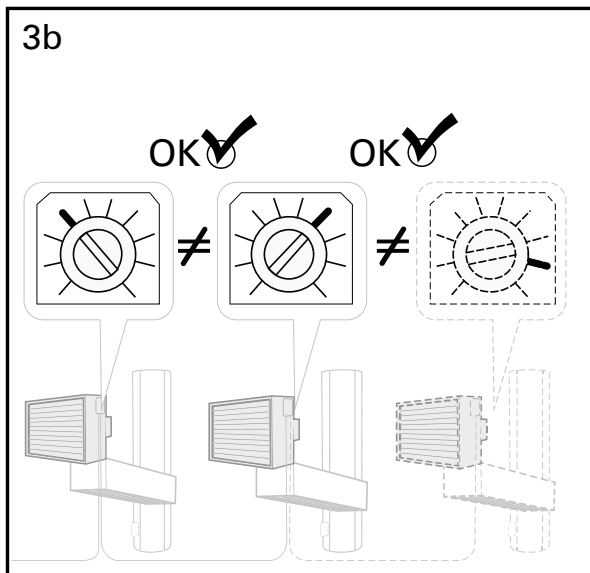
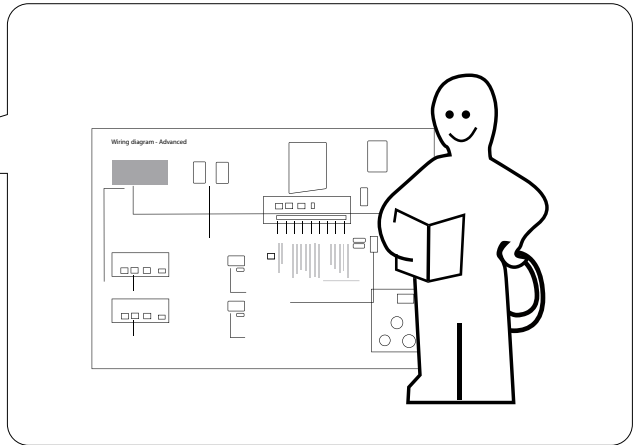
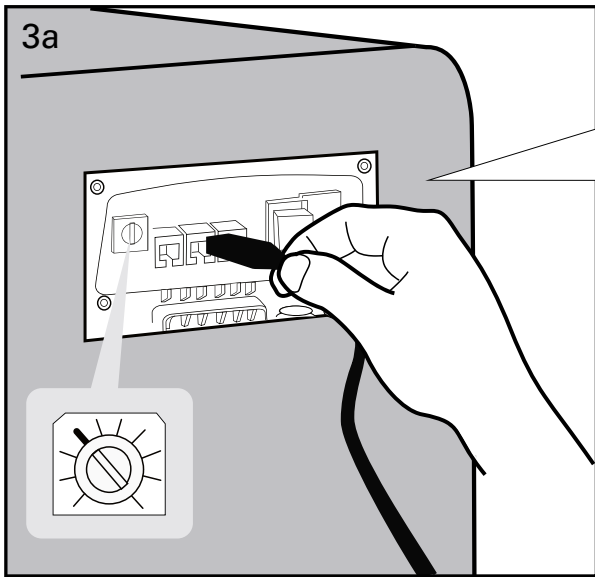

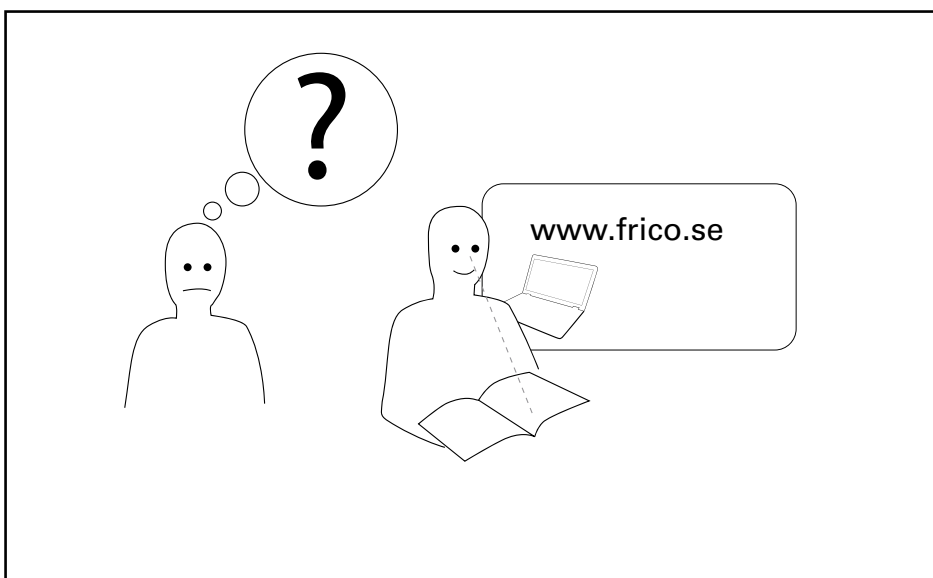
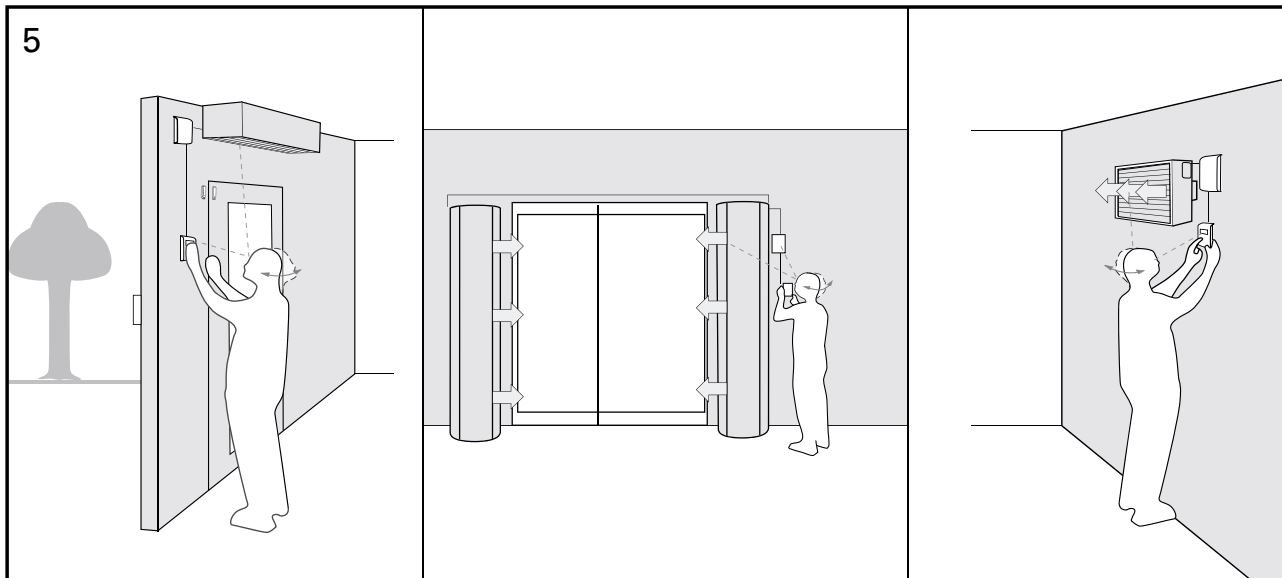

UA1Y	UA1Z
Svenska	Polski
Norsk	Русский
English	English
Deutsch	Čeština
Français	Slovenčina
Italiano	Türkçe
Español	Português
Nederlands	Română
Suomi	Magyar
Dansk	Українська

SIRe Competent

SIReAC SIReFC

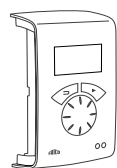

SIReUA1

+

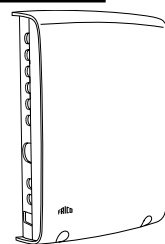
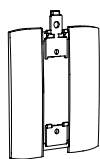

SIReC1X



SIReDC
(SIReAC)

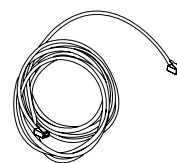

SIReCC

SE

Beståndsdelar

Typ	Beskrivning	HxBxD [mm]	L [m]
SIReUA1	Kontrollenhet, med inbyggd rumssensor, Döstätlock	120x70x35	
SIReC1X	Styrkort HUB Competent	202x139x50	
SIReDC	Magnetisk dörrkontakt		
SIReCC603	Modularkabel RJ12 (6/6)		3
SIReCC605	Modularkabel RJ12 (6/6)		5

GB

Constituent parts

Type	Description	HxWxD [mm]	L [m]
SIReUA1	Control unit, with internal room sensor, Wall unit cover	120x70x35	
SIReC1X	PC Board HUB Competent	202x139x50	
SIReDC	Magnetic door contact		
SIReCC603	Modular cable RJ12 (6/6)		3
SIReCC605	Modular cable RJ12 (6/6)		5

DE

Bestandteile

Typ	Beschreibung	HxBxT [mm]	L [m]
SIReUA1	Kontrolleinheit, mit Innenraumfühler, Wandgerät-Abdeckung	120x70x35	
SIReC1X	Steuerkarte HUB Competent	202x139x50	
SIReDC	Magnetischer Türkontakt		
SIReCC603	Modulares Kabel RJ12 (6/6)		3
SIReCC605	Modulares Kabel RJ12 (6/6)		5

FR
Pièces constitutives

Type	Désignation	HxLxP [mm]	L [m]
SIReUA1	Unité de contrôle avec sonde d'ambiance interne, protection de boîtier mural.	120x70x35	
SIReC1X	Carte électronique HUB Competent	202x139x50	
SIReDC	Contact de position magnétique		
SIReCC603	Câble modulaire RJ12 (6/6)		3
SIReCC605	Câble modulaire RJ12 (6/6)		5

ES
Componentes

Tipo	Descripción	HxWxD [mm]	L [m]
SIReUA1	Unidad de control, Con sensor de ambiente interno, Tapa para unidad de pared	120x70x35	
SIReC1X	Tarjeta hub pc competent	202x139x50	
SIReDC	Contacto de puerta		
SIReCC603	Cable modular Rj12 (6/6)		3
SIReCC605	Cable modular Rj12 (6/6)		5

IT
Componenti

Tipo	Descrizione	HxLxP [mm]	L [m]
SIReUA1	Unità di controllo, con sensore interno della temperatura ambiente, copertura per unità a parete	120x70x35	
SIReC1X	HUB scheda PC Competent	202x139x50	
SIReDC	Contatto magnetica per porta		
SIReCC603	Cavo modulare RJ12 (6/6)		3
SIReCC605	Cavo modulare RJ12 (6/6)		5

NL
Onderdelen

Typ	Omschrijving	HxWxD [mm]	L [m]
SIReUA1	Regelunit, met interne kamersensor, kap wandgemonteerde unit	120x70x35	
SIReC1X	Hub printplaat competent	202x139x50	
SIReDC	Deurcontact		
SIReCC603	Modulaire kabel Rj12 (6/6)		3
SIReCC605	Modulaire kabel Rj12 (6/6)		5

NO

Bestanddeler

Type	Beskrivelse	HxBxD [mm]	L [m]
SIReUA1	Kontrollenhet, med intern romføler, deksel til veggenhet	120x70x35	
SIReC1X	PC Board HUB Competent	202x139x50	
SIReDC	Dørkontakt		
SIReCC603	Modulærkabel RJ12 (6/6)		3
SIReCC605	Modulærkabel RJ12 (6/6)		5

PL

Części składowe

Typ	Opis	HxWxD [mm]	L [m]
SIReUA1	Sterownik z wewnętrznym czujnikiem temperatury pomieszczenia i pokrywą ścienną	120x70x35	
SIReC1X	Karta PC HUB Competent	202x139x50	
SIReDC	Czujnik drzwiowy		
SIReCC603	Kabel modułowy Rj12 (6/6)		3
SIReCC605	Kabel modułowy Rj12 (6/6)		5

RU

Комплекующие элементы

Модель	Описание	Габариты [мм]	L [м]
SIReUA1	Панель управления, с датчиком комнатной температуры, с накладкой на стену	120x70x35	
SIReC1X	Управляющая плата системы Профи	202x139x50	
SIReDC	Дверной Контакт		
SIReCC603	Кабель С Разъемами RJ12 (6/6)		3
SIReCC605	Кабель С Разъемами RJ12 (6/6)		5

FI

Osat

Malli	Kuvaus	KxLxS [mm]	P [m]
SIReUA1	Ohjauksyksikkö sisäisellä huoneanturilla, pinta-asennus	120x70x35	
SIReC1X	Piirikortti HUB Competent	202x139x50	
SIReDC	Ovikosketin		
SIReCC603	Modulaarikaapeli RJ12 (6/6)		3
SIReCC605	Modulaarikaapeli RJ12 (6/6)		5

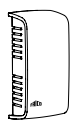

SIReRTX

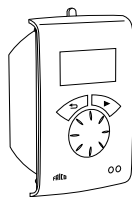

SIReUR



SIReCJ4



SIReCJ6

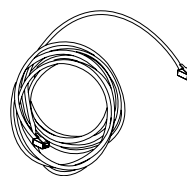

SIReCC

SE

Tillval

Typ	RSK-nr	E-nr	Beskrivning	HxBxD [mm]	L [m]
SIReRTX	673 09 22	87 510 12	Extern rumstemperaturgivare	70x33x23	10
SIReUR*	673 09 21	87 510 11	Kit för infällt montage	114x70x50	
SIReCJ4	673 09 70	87 510 33	Skarvstycke för två st. RJ11 (4/4)		
SIReCJ6	673 09 71	87 510 34	Skarvstycke för två st. RJ12 (6/6)		
SIReCC603	673 09 23	87 510 13	Modularkabel RJ12 (6/6)		3
SIReCC605	673 09 24	87 510 14	Modularkabel RJ12 (6/6)		5
SIReCC610	673 09 25	87 510 15	Modularkabel RJ12 (6/6)		10
SIReCC615	673 09 26	87 510 16	Modularkabel RJ12 (6/6)		15
SIReCC640	673 18 79	87 510 45	Modularkabel RJ12 (6/6)		40
SIReCC403	673 09 27	87 510 17	Modularkabel RJ11 (4/4)		3
SIReCC405	673 09 28	87 510 18	Modularkabel RJ11 (4/4)		5
SIReCC410	673 09 29	87 510 19	Modularkabel RJ11 (4/4)		10
SIReCC415	673 09 30	87 510 20	Modularkabel RJ11 (4/4)		15

*) Se separat manual.

GB

Option

Type	Description	HxWxD [mm]	L [m]
SIReRTX	External room temperature sensor	70x33x23	10
SIReUR*	Kit for recessed installation	114x70x50	
SIReCJ4	Joint piece for two pcs. RJ11 (4/4)		
SIReCJ6	Joint piece for two pcs. RJ12 (6/6)		
SIReCC603	Modular cable RJ12 (6/6)		3
SIReCC605	Modular cable RJ12 (6/6)		5
SIReCC610	Modular cable RJ12 (6/6)		10
SIReCC615	Modular cable RJ12 (6/6)		15
SIReCC640	Modular cable RJ12 (6/6)		40
SIReCC403	Modular cable RJ11 (4/4)		3
SIReCC405	Modular cable RJ11 (4/4)		5
SIReCC410	Modular cable RJ11 (4/4)		10
SIReCC415	Modular cable RJ11 (4/4)		15

*) See separate manual.

DE

Optional

Typ	Beschreibung	HxBxT [mm]	L [m]
SIReRTX	Externer Raumtemperatursensor	70x33x23	10
SIReUR*	Kit für versenkte Installation	114x70x50	
SIReCJ4	Verbindungsstück für zwei Teile RJ11 (4/4)		
SIReCJ6	Verbindungsstück für zwei Teile RJ12 (6/6)		
SIReCC603	Modulares Kabel RJ12 (6/6)		3
SIReCC605	Modulares Kabel RJ12 (6/6)		5
SIReCC610	Modulares Kabel RJ12 (6/6)		10
SIReCC615	Modulares Kabel RJ12 (6/6)		15
SIReCC640	Modulares Kabel RJ12 (6/6)		40
SIReCC403	Modulares Kabel RJ11 (4/4)		3
SIReCC405	Modulares Kabel RJ11 (4/4)		5
SIReCC410	Modulares Kabel RJ11 (4/4)		10
SIReCC415	Modulares Kabel RJ11 (4/4)		15

*) Siehe separates Handbuch.

FR

Option

Type	Désignation	HxLxP [mm]	L [m]
SIReRTX	Sonde de température ambiante déportée	70x33x23	10
SIReUR*	Kit pour installation encastrée	114x70x50	
SIReCJ4	Pièce de jonction pour deux pcs. RJ11 (4/4)		
SIReCJ6	Pièce de jonction pour deux pcs. RJ12 (6/6)		
SIReCC603	Câble modulaire RJ12 (6/6)		3
SIReCC605	Câble modulaire RJ12 (6/6)		5
SIReCC610	Câble modulaire RJ12 (6/6)		10
SIReCC615	Câble modulaire RJ12 (6/6)		15
SIReCC640	Câble modulaire RJ12 (6/6)		40
SIReCC403	Câble modulaire RJ11 (4/4)		3
SIReCC405	Câble modulaire RJ11 (4/4)		5
SIReCC410	Câble modulaire RJ11 (4/4)		10
SIReCC415	Câble modulaire RJ11 (4/4)		15

*) Consultez le manuel associé.

ES

Opciones

Tipo	L [m]	HxWxD [mm]	L [m]
SIReRTX		70x33x23	10
SIReUR*		114x70x50	
SIReCJ4			
SIReCJ6			
SIReCC603			3
SIReCC605			5
SIReCC610			10
SIReCC615			15
SIReCC640			40
SIReCC403			3
SIReCC405			5
SIReCC410			10
SIReCC415			15

*) Consulte el manual correspondiente.

IT

Opzione

Typo	Descrizione	HxLxP [mm]	L [m]
SIReRTX	Sensore esterno della temperatura ambiente	70x33x23	10
SIReUR*	Kit per installazione incassata	114x70x50	
SIReCJ4	Elemento di giunzione RJ11 (4/4)		
SIReCJ6	Elemento di giunzione RJ12 (6/6)		
SIReCC603	Cavo modulare RJ12 (6/6)		3
SIReCC605	Cavo modulare RJ12 (6/6)		5
SIReCC610	Cavo modulare RJ12 (6/6)		10
SIReCC615	Cavo modulare RJ12 (6/6)		15
SIReCC640	Cavo modulare RJ12 (6/6)		40
SIReCC403	Cavo modulare RJ11(4/4)		3
SIReCC405	Cavo modulare RJ11(4/4)		5
SIReCC410	Cavo modulare RJ11 (4/4)		10
SIReCC415	Cavo modulare RJ11(4/4)		15

*) Vedere il manuale specifico.

NL

Optie

Typ	Omschrijving	HxWxD [mm]	L [m]
SIReRTX	External room temperature sensor	70x33x23	10
SIReUR*	Kit for recessed installation	114x70x50	
SIReCJ4	Koppelstuk voor twee stuks RJ11 (4/4)		
SIReCJ6	Koppelstuk voor twee stuks RJ12 (6/6)		
SIReCC603	Modulaire kabel RJ12 (6/6)		3
SIReCC605	Modulaire kabel RJ12 (6/6)		5
SIReCC610	Modulaire kabel RJ12 (6/6)		10
SIReCC615	Modulaire kabel RJ12 (6/6)		15
SIReCC640	Modulaire kabel RJ12 (6/6)		40
SIReCC403	Modulaire kabel RJ11 (4/4)		3
SIReCC405	Modulaire kabel RJ11 (4/4)		5
SIReCC410	Modulaire kabel RJ11 (4/4)		10
SIReCC415	Modulaire kabel RJ11 (4/4)		15

*) Zie aparte handleiding.

NO

Ekstraustyr

Type	NRF-no.	EL-no.	Beskrivelse	HxBxD [mm]	L [m]
SIReRTX	85 022 94	54 910 01	Ekstern romtemperaturføler	70x33x23	10
SIReUR*	85 022 93	49 325 00	Sett for innfelt montering	114x70x50	
SIReCJ4		54 910 02	Skjøtestykke RJ11 (4/4)		
SIReCJ6			Skjøtestykke RJ12 (6/6)		
SIReCC603	85 022 95	54 329 01	Modulærkabel RJ12 (6/6)		3
SIReCC605	85 022 96	54 329 02	Modulærkabel RJ12 (6/6)		5
SIReCC610	85 022 97	54 329 03	Modulærkabel RJ12 (6/6)		10
SIReCC615	85 022 98	54 329 04	Modulærkabel RJ12 (6/6)		15
SIReCC640			Modulærkabel RJ12 (6/6)		40
SIReCC403	85 022 99	54 329 05	Modulærkabel RJ11 (4/4)		3
SIReCC405	85 023 01	54 329 06	Modulærkabel RJ11 (4/4)		5
SIReCC410	85 023 02	54 329 07	Modulærkabel RJ11 (4/4)		10
SIReCC415	85 023 03	54 329 08	Modulærkabel RJ11 (4/4)		15

*) Se egen håndbok.

PL

Опция

Тип	Опис	HxWxD [mm]	L [m]
SIReRTX	Zewnętrzny czujnik temperatury pomieszczenia	70x33x23	10
SIReUR*	Zestaw do zabudowy	114x70x50	
SIReCJ4	Połączenie. RJ11 (4/4)		
SIReCJ6	Połączenie. RJ12 (6/6)		
SIReCC603	Kabel modułowy RJ12 (6/6)		3
SIReCC605	Kabel modułowy RJ12 (6/6)		5
SIReCC610	Kabel modułowy RJ12 (6/6)		10
SIReCC615	Kabel modułowy RJ12 (6/6)		15
SIReCC640	Kabel modułowy RJ12 (6/6)		40
SIReCC403	Kabel modułowy RJ11 (4/4)		3
SIReCC405	Kabel modułowy RJ11 (4/4)		5
SIReCC410	Kabel modułowy RJ11 (4/4)		10
SIReCC415	Kabel modułowy RJ11 (4/4)		15

*) Patrz oddzielna instrukcja.

RU

Принадлежности

Модель	Описание	Габариты [мм]	L [м]
SIReRTX	Внешний датчик комнатной температуры	70x33x23	10
SIReUR*	Блок управления для установки в стену	114x70x50	
SIReCJ4	Разъем RJ11 (4/4)		
SIReCJ6	Разъем RJ12 (6/6)		
SIReCC603	Кабель с разъемами RJ12 (6/6)		3
SIReCC605	Кабель с разъемами RJ12 (6/6)		5
SIReCC610	Кабель с разъемами RJ12 (6/6)		10
SIReCC615	Кабель с разъемами RJ12 (6/6)		15
SIReCC640	Кабель с разъемами RJ12 (6/6)		40
SIReCC403	Кабель с разъемами RJ11 (4/4)		3
SIReCC405	Кабель с разъемами RJ11 (4/4)		5
SIReCC410	Кабель с разъемами RJ11 (4/4)		10
SIReCC415	Кабель с разъемами RJ11 (4/4)		15

*) См. отдельную инструкцию.

FI

Vaihtoehdot

Malli	Kuvaus	KxLxS [mm]	P [m]
SIReRTX	Ulkoinen huonelämpötila-anturi	70x33x23	10
SIReUR*	Uppoasennussarja	114x70x50	
SIReCJ4	Jatkoliitin 2xRJ11(4/4)		
SIReCJ6	Jatkoliitin 2xRJ11(4/4)		
SIReCC603	Modulaarikaapeli RJ12 (6/6)		3
SIReCC605	Modulaarikaapeli RJ12 (6/6)		5
SIReCC610	Modulaarikaapeli RJ12 (6/6)		10
SIReCC615	Modulaarikaapeli RJ12 (6/6)		15
SIReCC640	Modulaarikaapeli RJ12 (6/6)		40
SIReCC403	Modulaarikaapeli RJ11 (4/4)		3
SIReCC405	Modulaarikaapeli RJ11 (4/4)		5
SIReCC410	Modulaarikaapeli RJ11 (4/4)		10
SIReCC415	Modulaarikaapeli RJ11 (4/4)		15

*) Katso erillinen käyttöohje.

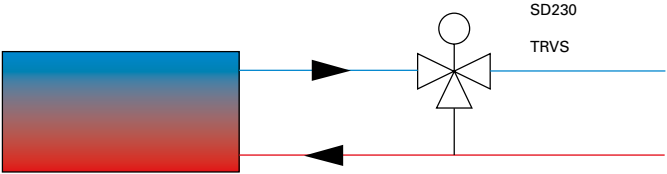
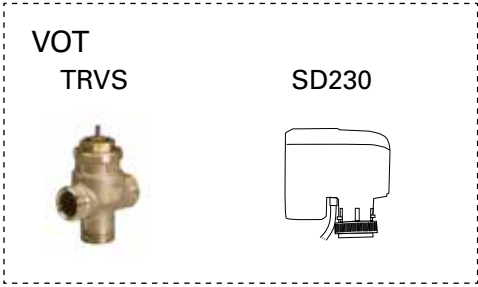
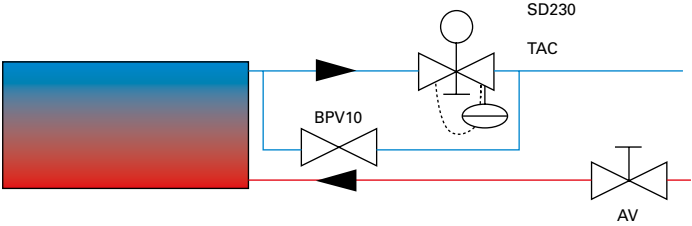
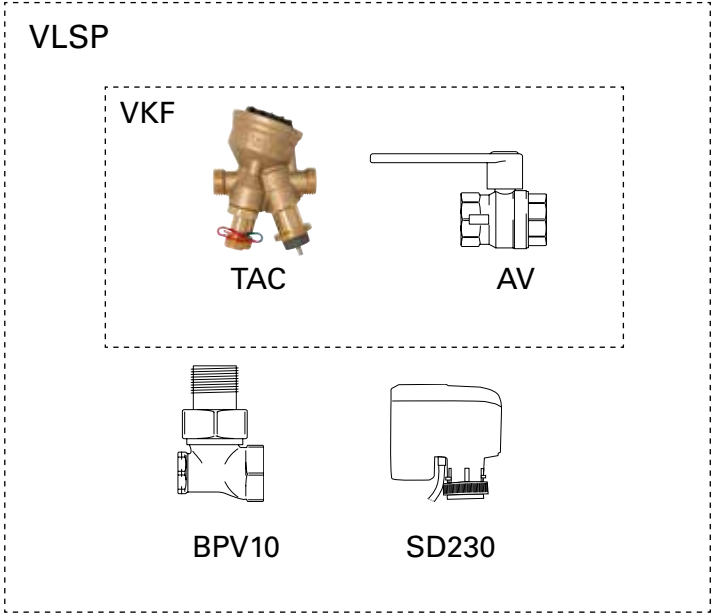

SE

Vattenreglering - ventilpaket*

Typ	RSK-nr	Komponenter	Anslutning
VLSP15LF	670 45 35	VKF15LF + SD230 + BPV10	DN15
VLSP15NF	670 45 36	VKF15NF + SD230 + BPV10	DN15
VLSP20	670 45 37	VKF20 + SD230 + BPV10	DN20
VLSP25	670 45 38	VKF25 + SD230 + BPV10	DN25
VLSP32	670 45 39	VKF32 + SD230 + BPV10	DN32

*) Se separata manualer.

GB

Water control - valve system*

Type	Description	Connection
VLSP15LF	Pressure independent	DN15
VLSP15NF	Pressure independent	DN15
VLSP20	Pressure independent	DN20
VLSP25	Pressure independent	DN25
VLSP32	Pressure independent	DN32
VOT15	Three way valve and actuator on/off	DN15
VOT20	Three way valve and actuator on/off	DN20
VOT25	Three way valve and actuator on/off	DN25

*) See separate manuals.

DE

Wasserregelung - Ventilsystem*

Typ	Beschreibung	Anschluss
VLSP15LF	Druckunabhängig	DN15
VLSP15NF	Druckunabhängig	DN15
VLSP20	Druckunabhängig	DN20
VLSP25	Druckunabhängig	DN25
VLSP32	Druckunabhängig	DN32
VOT15	3-Wege-Regelventil mit Stellmotor, Ein/Aus	DN15
VOT20	3-Wege-Regelventil mit Stellmotor, Ein/Aus	DN20
VOT25	3-Wege-Regelventil mit Stellmotor, Ein/Aus	DN25

*) siehe separates Handbuch.

FR

Régulation hydraulique - système de vannes*

Type	Désignation	Raccordement
VLSP15LF	Indépendant de la pression	DN15
VLSP15NF	Indépendant de la pression	DN15
VLSP20	Indépendant de la pression	DN20
VLSP25	Indépendant de la pression	DN25
VLSP32	Indépendant de la pression	DN32
VOT15	Vanne à trois voies	DN15
VOT20	Vanne à trois voies	DN20
VOT25	Vanne à trois voies	DN25

*) Consultez les manuels associés.

ES

Control del agua - sistema de válvulas*

Tipo	Descripción	Conexión
VLSP15LF	Independiente de la presión	DN15
VLSP15NF	Independiente de la presión	DN15
VLSP20	Independiente de la presión	DN20
VLSP25	Independiente de la presión	DN25
VLSP32	Independiente de la presión	DN32
VOT15	Válvula de 3 vías y actuador on/off	DN15
VOT20	Válvula de 3 vías y actuador on/off	DN20
VOT25	Válvula de 3 vías y actuador on/off	DN25

*) Consulte el manual correspondiente.

IT

Controllo dell'acqua - sistema di valvole*

Tipo	Descrizione	Collegamento
VLSP15LF	Indipendente dalla pressione	DN15
VLSP15NF	Indipendente dalla pressione	DN15
VLSP20	Indipendente dalla pressione	DN20
VLSP25	Indipendente dalla pressione	DN25
VLSP32	Indipendente dalla pressione	DN32
VOT15	Valvola a tre vie e attuatore aperto/chiuso	DN15
VOT20	Valvola a tre vie e attuatore aperto/chiuso	DN20
VOT25	Valvola a tre vie e attuatore aperto/chiuso	DN25

*) vedere i manuali specifici.

NL

Waterregeling - kleppensysteem*

Type	Omschrijving	Aansluiting
VLSP15LF	Drukafhankelijke	DN15
VLSP15NF	Drukafhankelijke	DN15
VLSP20	Drukafhankelijke	DN20
VLSP25	Drukafhankelijke	DN25
VLSP32	Drukafhankelijke	DN32
VOT15	Driewegventiel en magneetventiel aan/uit.	DN15
VOT20	Driewegventiel en magneetventiel aan/uit.	DN20
VOT25	Driewegventiel en magneetventiel aan/uit.	DN25

*) Zie aparte handleidingen

NO

Vannregulering - ventilsystem*

Type	Beskrivelse	Tilkobling
VLSP15LF	Trykkuavhengig	DN15
VLSP15NF	Trykkuavhengig	DN15
VLSP20	Trykkuavhengig	DN20
VLSP25	Trykkuavhengig	DN25
VLSP32	Trykkuavhengig	DN32
VOT15	Treveisventil og regulator på/av	DN15
VOT20	Treveisventil og regulator på/av	DN20
VOT25	Treveisventil og regulator på/av	DN25

*) Se egne håndbøker.

PL

Regulacja przepływu wody – zestaw zaworów*

Typ	Opis	Podłączenie
VLSP15LF	Zestaw zaworów, dwupołożeniowy, niezależny od ciśnienia	DN15
VLSP15NF	Zestaw zaworów, dwupołożeniowy, niezależny od ciśnienia	DN15
VLSP20	Zestaw zaworów, dwupołożeniowy, niezależny od ciśnienia	DN20
VLSP25	Zestaw zaworów, dwupołożeniowy, niezależny od ciśnienia	DN25
VLSP32	Zestaw zaworów, dwupołożeniowy, niezależny od ciśnienia	DN32
VOT15	3-drogowy zawór regulacyjny i siłownik dwupołożeniowy	DN15
VOT20	3-drogowy zawór regulacyjny i siłownik dwupołożeniowy	DN20
VOT25	3-drogowy zawór regulacyjny i siłownik dwupołożeniowy	DN25

*) Patrz oddzielne instrukcje.

RU

Регулировка расхода воды - комплект клапанов*

Модель	Описание	Соединение
VLSP15LF	Комплект клапанов on/off с функцией пост. расхода	DN15
VLSP15NF	Комплект клапанов on/off с функцией пост. расхода	DN15
VLSP20	Комплект клапанов on/off с функцией пост. расхода	DN20
VLSP25	Комплект клапанов on/off с функцией пост. расхода	DN25
VLSP32	Комплект клапанов on/off с функцией пост. расхода	DN32
VOT15	3-х ходовой клапан и электропривод on/off	DN15
VOT20	3-х ходовой клапан и электропривод on/off	DN20
VOT25	3-х ходовой клапан и электропривод on/off	DN25

*) смотрите отдельную инструкцию.

FI

Veden säätö - venttiilisarja*

Malli	Kuvaus	Kytkentä
VLSP15LF	Painevakioitu venttiilisarja on/off	DN15
VLSP15NF	Painevakioitu venttiilisarja on/off	DN15
VLSP20	Painevakioitu venttiilisarja on/off	DN20
VLSP25	Painevakioitu venttiilisarja on/off	DN25
VLSP32	Painevakioitu venttiilisarja on/off	DN32

*) Katso erillinen käyttöohje.

Quick guide/Start up

1. Check that all constituent parts are present (see section Constituent parts).
2. Mount and connect all units and components and where applicable accessories (e.g. actuator), see wiring diagram. When several units are connected set a unique ID for each unit (1-9) which is set in the ID selector of the SIReB1/B2/B1EC.

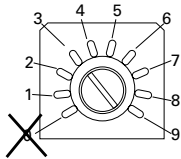
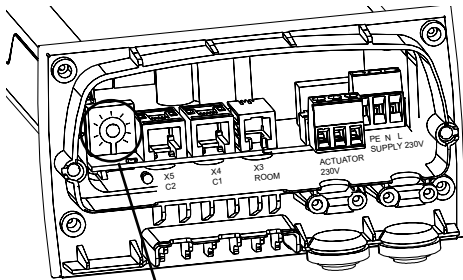

Each unit should have a unique ID on its SIReB1/B2/B1EC card.

Operation without control unit

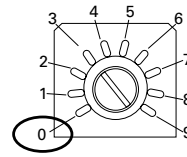





To run the unit temporarily without external control select mode 0.

3. Power up all units.
4. The start-up wizard runs and basic settings are made. The system check identifies connected components in the system and the function test shows if all units are correctly connected.

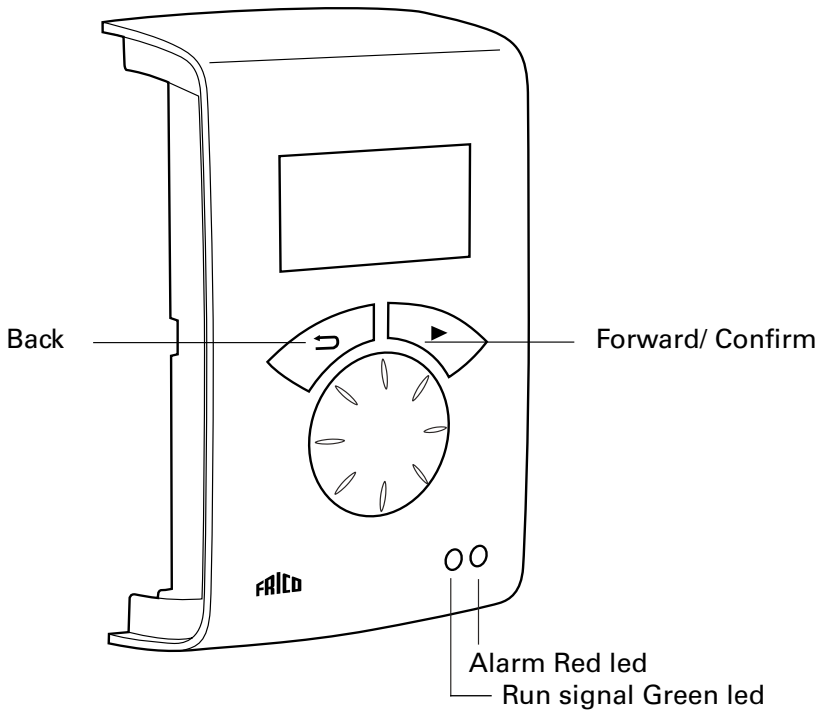

Control unit SIReUA1

Overview

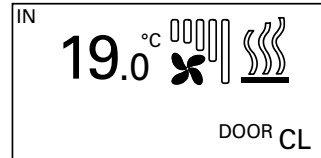

Air curtains   
SIRe AC



Fan heaters  
SIRe FC
Auto

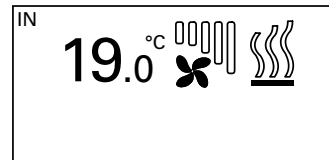

Manual mode

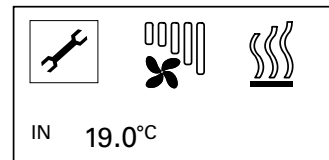

Fan speed step



Heating step



Week program
Day



Week program
Night

OFF

Week program
Out of operation



Manual operation (SIReFC)

Main menu

Current settings

Current set values.

Temperature settings

Day/night temperature. The night temperature is only valid when the week program is activated.

Installer menu

Password 1932

Installer status screen

Current settings and functions.

Week program

Activate week program, check, change, add or erase program.

Fan settings

Fan control and over run functions.

Heating settings

Set point difference open door, (calibrating sensors).

Fan control

Maximum fan speed and fan speed when the door is closed. Fan speed when the door is closed is only valid when using SIReAC.

Summer/Winter

Summer - heat off

System on/off

Safety features are still active when the system is switched off.

Filter guard settings

Activate filter timer and set service interval.

External control (BMS)

External on/off, fan control 0-10V. See "Connecting external control".

General settings

Language, time, date, function test, manual system check and factory reset.

Support menu

The support menu is password protected and is used for support in contact with Frico or authorised installer.

Alarm and error codes

Reset alarm

Note! Before resetting, check that the fault is rectified and there is nothing to prevent the unit from being recommissioned.

Press ► and select reset alarm.

At the first start up alarm and error codes can occur, these will usually be reset without actions.

Power failure

Note! A power loss longer than 7 days may require an adjustment of time and date. The week program is affected if the clock is not correctly set.

Complete manual see www.frico.se

Table - Alarm

Error code		Cause	Action
A1	Motor alarm	Thermal contact has deployed. One or more motors are overheated.	<p>Check that nothing is obstructing the unit's air intake and exhaust.</p> <p>When the overheated motor has cooled the thermal switch shuts again and the alarm can be reset. At repeated alarms, check the motors, replace damaged motors.</p>
		Missing link on motor protection on SIReB1/B2/B1EC.	For units having built-in thermal protection but without external connection, the motor protection terminals must be linked.
		Unit won't start.	For units having built-in thermal protection but without external connection, the motor protection terminals must be linked.
—		Unit only starts on high speed.	Check motor and transformer connection terminal on the SIReB1/B2/B1EC-pc board.
A2	Over heating alarm	The temperature in the unit has exceeded the alarm limit for overheating. (Only units with internal temperature sensor)	Check that nothing is obstructing the unit's air intake and exhaust.
			Check function of the contactors (E), Check function of actuator and valve, flow temperature and bypass settings (W).
			Check internal temperature sensor, measure resistance, 47kOhm at 25°C.
A3	Frost protection alarm	The temperature in the unit has fallen below the alarm limit for frost protection (only water heated units with internal temperature sensor and/ or return water temperature sensor SIReWTA).	Check the function of the actuator, valve and bypass settings.
			Check the temperature and flow of the hot water supply.
			In event of an alarm there is a risk that the coil is damaged, check carefully for leakage and replace the water heating coil if damaged.
A4	Filter alarm	Fixed run time before filter alarm has been reached.	Replace or clean the filter, if necessary adjust the fixed time based on how dirty the filter was and reset the alarm.
		The external filter guard has been activated.	Replace or clean the filter, if necessary adjust settings of the filter guard based on how dirty the filter was and reset the alarm.
A5	External alarm	External alarm input (terminal 9-10) on SIReA1X/SIReC1X has been activated	Check the external alarm.

Table - Error codes

Error code	Cause	Action	
E1	Communication error	SIReB1/B2/B1EC (internal pc-board) do not communicate.	Try to reset the alarm. Check connections, modular cables and terminals, between all units and components. Systematically shift position of communication cables to identify a broken terminal or cables.
		ID is set to 0 (Unit is running continuously).	Set an ID, run a Manual system check.
		Cables are not original.	Make sure communication cables are correct (Frico original cables has a circuit diagram indicating how the contacts shall be crimped on to the cable.)
		The unit won't start.	In multiple unit system, check that you have 230VAC to all units.
			In <i>Installer menu - Installer status screen</i> , check that all units ID are listed and that no extra units are listed. When all units are powered up run a Manual system check.
			Disconnect power, set ID=0 and reconnect power to test the B1/B2/B1EC pc-board.
Perform a factory reset and reboot the system (disconnect/ reconnect power).			
Visual damage to SIReB1/B2/B1EC.	Hardware failure - replace the SIReB1/B2/B1EC pc-board. Contact Frico technical support.		
E2	ID Error	Two or more SIReB1/B2/B1EC have the same ID.	Try to reset the alarm. Make sure all units have different ID-settings and perform a Manual system check.
E3	Program error (No program)	One or more SIReB1/B2/B1EC do not have program.	Try to reset the alarm. Disconnect power, set ID=0 and reconnect power to test the B1/B2/B1EC pc-board - result? If the unit is running act as if it was an E1 Communication error. If it is not running, contact Frico technical support.
E4	Room sensor error	Fault on or missing external room sensor SIReRTX connected to SIReB1/B2/B1EC.	Try to reset the alarm. Check connections and cable. False errors can occur in conjunction with communication error, check that all other alarms have been reset. Measure resistance, 47kOhm at 25°C. If the sensor intentionally has been removed, run a Manual system check to exclude it from the system.
		Wrong temperature is displayed in SIReUA1.	If a return water sensor (SIReWTA) is connected but not activated, the system will interpret that value as a room temperature value, activate return water sensor. When SIReWTA is used, SIReRTX shall be connected to the SIReA1X.
E6	Return water temp. sensor error.	Fault on or missing Return water sensor SIReWTA connected to SIReB1/B2/B1EC.	Try to reset the alarm. Check connections and cable. False errors can occur in conjunction with communication error, check that all other alarms have been reset. Measure resistance, 47kOhm at 25°C. If the sensor intentionally has been removed, run a Manual system check to exclude it from the system.
		Wrong temperature is displayed in SIReUA1.	Return water temperature sensor is activated with a SIReRTX-sensor connected - In the menu, disable return water temperature sensor.

E7	Return water temp. sensor error.	Fault on or missing, mandatory Return water sensor SIReWTA connected to SIReB1/B2/B1EC.	Try to reset the alarm. Check connections and cable. False errors can occur in conjunction with communication error, check that all other alarms have been reset. Measure resistance, 47kOhm at 25°C.
		Wrong temperature is displayed in SIReUA1.	Confirm that WTA is connected to the SIReB1/B2/B1EC and securely fastened to the return water pipe and compare with what the actual temperature is. SIReRTX-sensor must not be connected to SIReB1/B2/B1EC when the intention is to use return water sensor. When SIReWTA is used, SIReRTX shall be connected to the SIReA1X
E8	Internal sensor Error	Fault on or missing internal temperature sensor, SIReIT, connected to SIReB1/B2/B1EC.	Try to reset the alarm. Check connections and cable. False errors can occur in conjunction with communication error, check that all other alarms have been reset. Measure resistance, 47kOhm at 25°C.
E10	Program error (different programs)	Two or more SIReB1/B2/B1EC in the system have different programs.	Try to reset the alarm. SIRe can control different types of units, e.g. Fan heaters or air curtains, water or electrical units, but they cannot be combined. The only exception is ambient air curtains in combination with either electrical or water heated units of the same model. Check the datalabels of your units and contact Frico technical support.
E12	Room sensor error	Fault on or missing external room sensor, SIReRTX connected to SIReA1X/C1X.	Try to reset the alarm. Check connections and cable. False errors can occur in conjunction with communication error, check that all other alarms have been reset. Measure resistance, 47kOhm at 25°C.
E14	Outdoor sensor error	Fault on or missing, mandatory outdoor temperature sensor, SIReOTX, connected to SIReA1X.	Try to reset the alarm. Check connections and cable. False errors can occur in conjunction with communication error, check that all other alarms have been reset. Measure resistance, 47kOhm at 25°C.
E20	Communication error	SIReA1X/C1X (external pc-board) do not communicate.	Try to reset the alarm. Check connections, modular cables and terminals, between all units and components. Systematically shift position of communication cables to identify a broken terminal or cables.
		Cables are not original.	Make sure communication cables are correct (Frico original cables has a circuit diagram indicating how the contacts shall be crimped on to the cable.)
E21	Room sensor error	Fault on internal room temperature sensor in SIReUA1.	Try to reset the alarm. Check connections and cable. False errors can occur in conjunction with communication error, check that all other alarms have been reset. If the error is not rectified SIReUA1 must be replaced.
E22	Multiple control units connected	Logging tool or an extra control unit SIReUA1 is connected to the system.	Try to reset the alarm. The system will only support one control unit, disconnect and reset alarm.
E23	Firmware error	Components of different releases are used in the system.	Make sure all units are from the same release, contact Frico technical support.

Connecting external control - including BMS functions

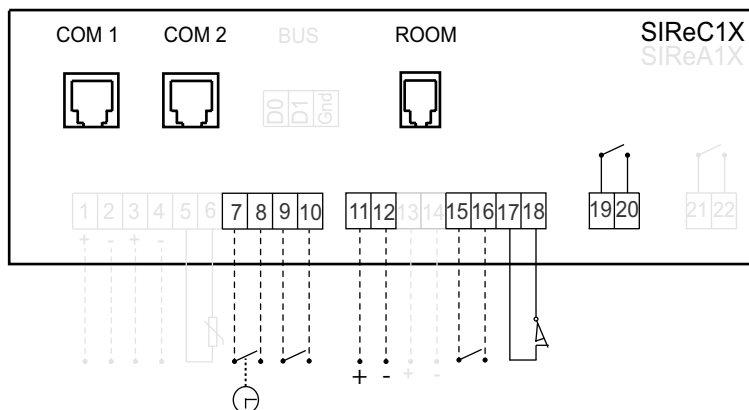

Terminal	Functions
COM1	RJ12 (6/6) SIRe internal communication
COM2	RJ12 (6/6) SIRe internal communication
D0	BUS
D1	Modbus/RTU via Rs-485.
Gnd	See separate manual: SIRe Modbus
ROOM	RJ11 (4/4) Pin 1+2 and 3+4, SIReRTX (accessory)

1+	<u>RPM indication</u>	13	<u>External heat control</u>
2-	0-10V DC OUT (max 5 mA). Signal from SIRe indicates 0-100 % fan speed. Always active.	14	0-10V DC IN. Control heat 0-100 %. Set parameter: Installer menu > External control > 0-10V heating control = On
3+	<u>Heat indication</u> (Actuator control)	15	<u>External on/off</u>
4-	0-10V DC OUT (max 5 mA). Signal from SIRe indicates 0-100 % heat step. Control signal to modulating actuator. Always active.	16	External voltfree (dry) contact. Closes to activate system. Set parameter: Installer menu > External control > External On/Off = On
5	<u>Outdoor sensor</u> (Mandatory)	17	<u>Door contact</u> (Mandatory)
6	SIReOTX (included).	18	External voltfree (dry) contact. SIReDC (included) or other contact (e.g. in BMS or door automatic). Door open = Closed contact Door closed = Open contact
7	<u>Setback temperature</u>	19	<u>BMS Alarm out</u>
8	External voltfree (dry) contact. Close to activate night temperature. Always active.	20	Internal voltfree (dry) contact, max 3A, 230V. Always active. Indicates alarm. Closed contact = Alarm Open contact = No alarm
9	<u>External alarm IN</u>	21	<u>BMS indication OUT</u>
10	External voltfree (dry) contact. Closes to indicate an alarm. If used for filter guard, set Parameter: Installer menu > Filter guard > External filter guard = On Always active.	22	Internal voltfree (dry) contact, max 3A, 230V. Always active. Indicates operation. Closed contact = In operation Open contact = Not in operation
11	<u>External rpm</u>		
12	0-10V DC IN. Control fan speed 0-100 %. Set parameter: Installer menu > External control > 0-10V Fan control = On		



Main office

Frico AB
Box 102
SE-433 22 Partille
Sweden

Tel: +46 31 336 86 00

mailbox@frico.se
www.frico.se

**For latest updated information and information
about your local contact: www.frico.se**