

Original instructions
SIRe Advanced
Quick guide

SIRe AA
SIRe FA

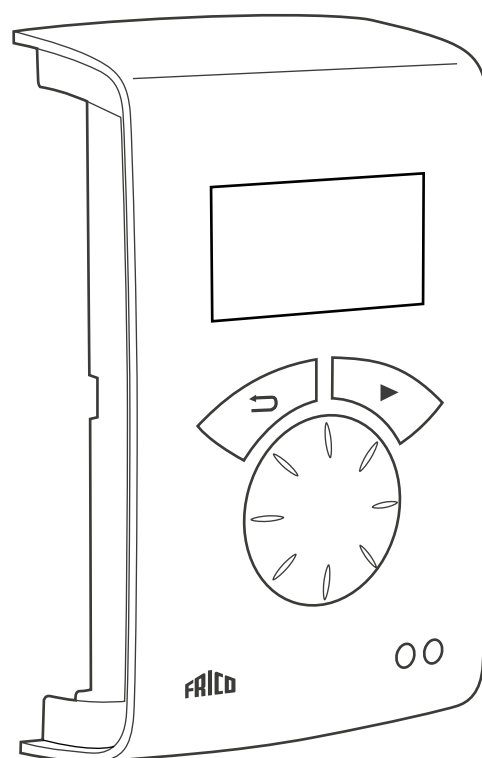

SE ... 18

GB ... 25

DE ... 32

FR ... 39

ES ... 46

IT ... 53

NL ... 60

NO ... 67

PL ... 74

RU ... 81

FI ... 89

Wiring diagram - Advanced
SIReAA/ SIReFA

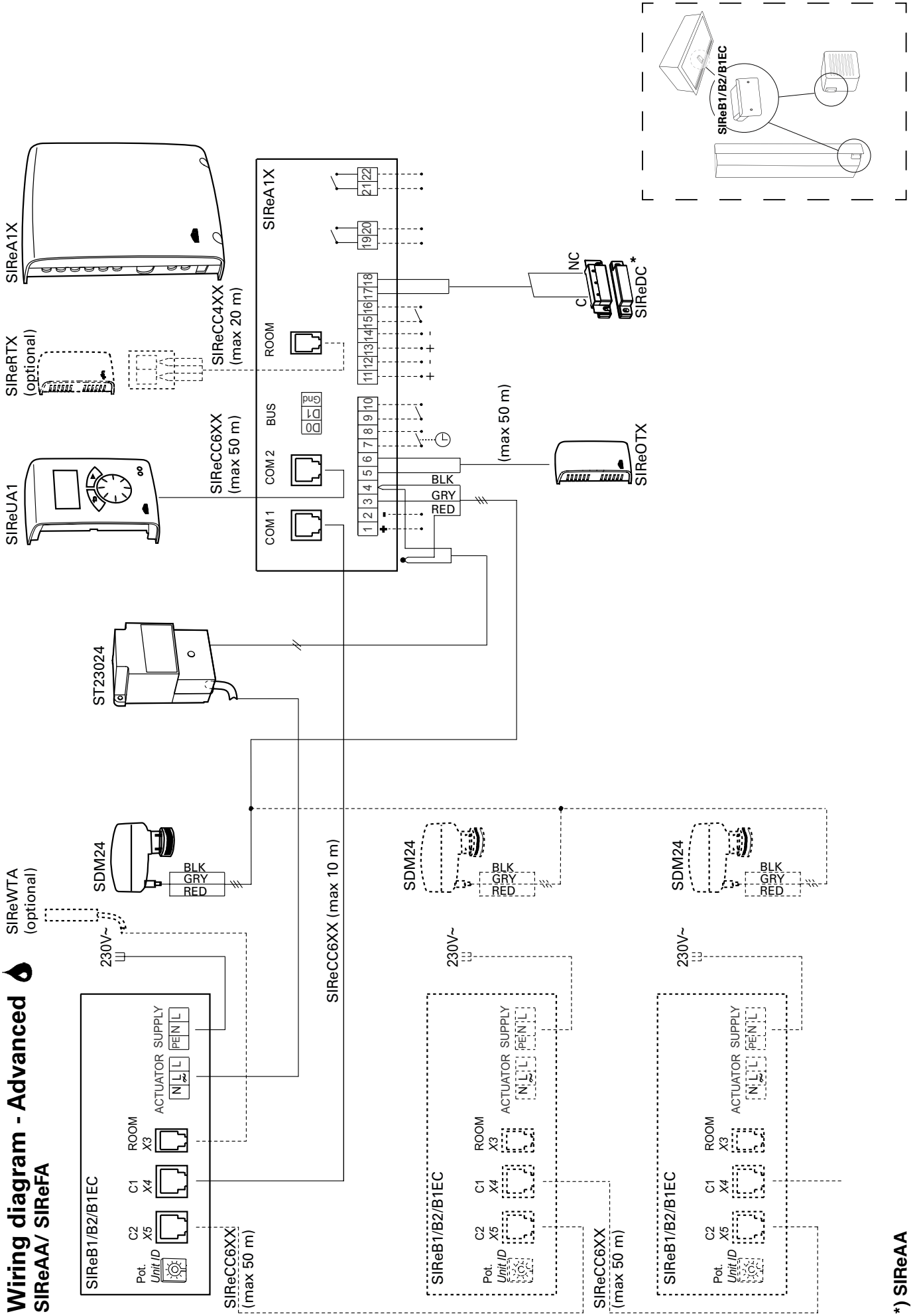

*) SIReAA

Wiring diagram - Advanced

SIReAA/ SIReFA

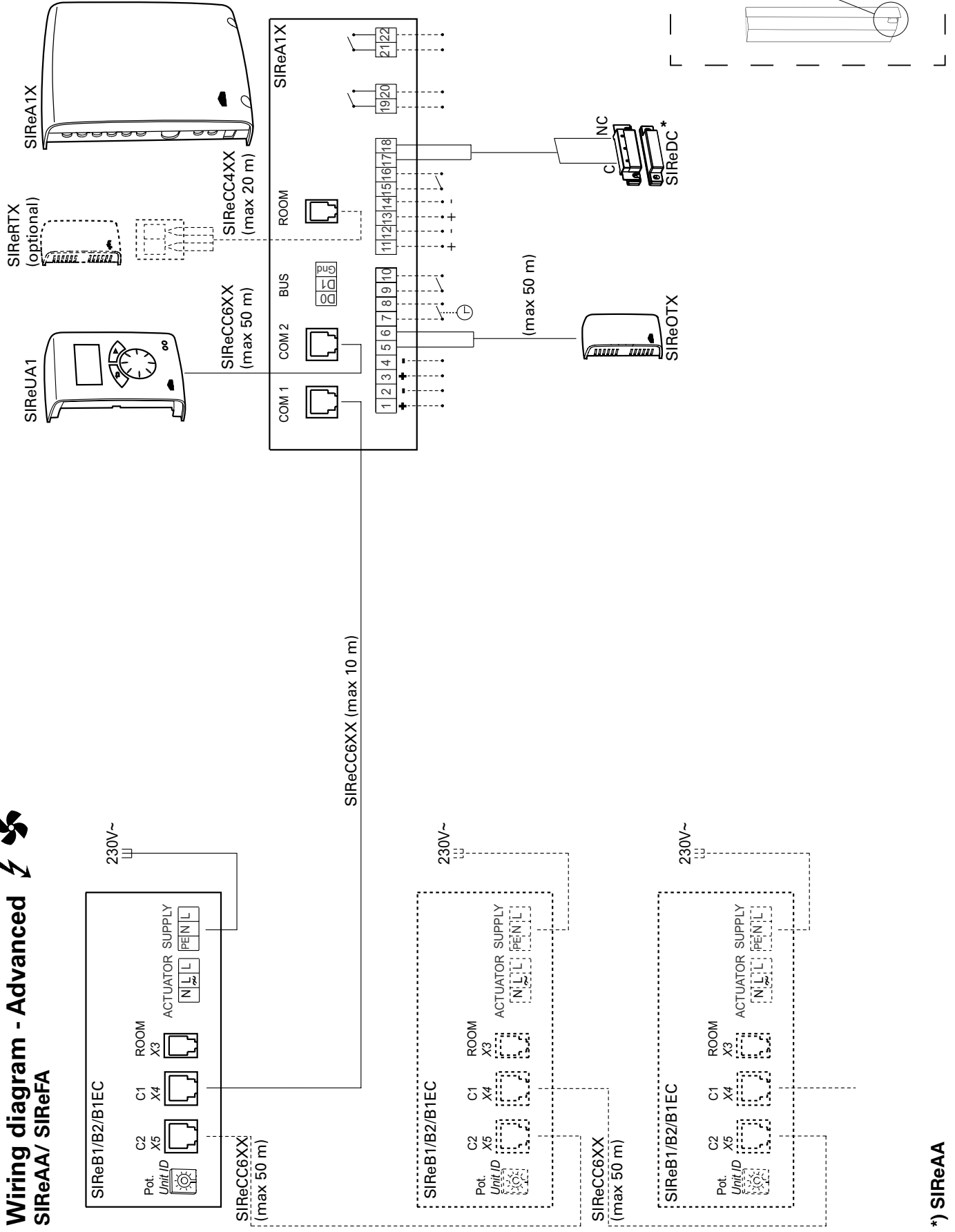

*) SIReAA

1

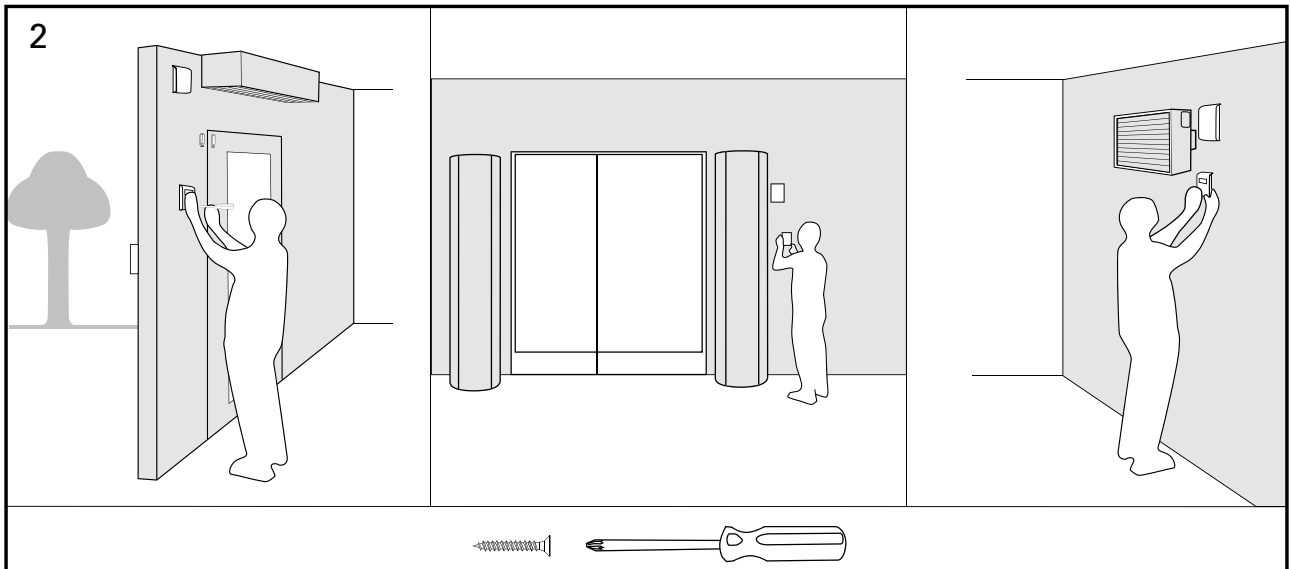
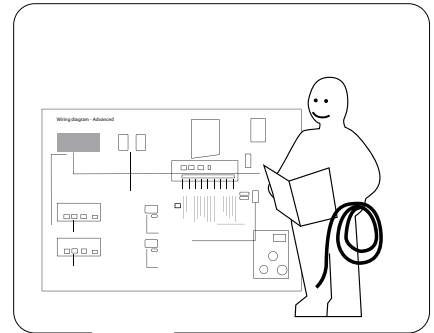
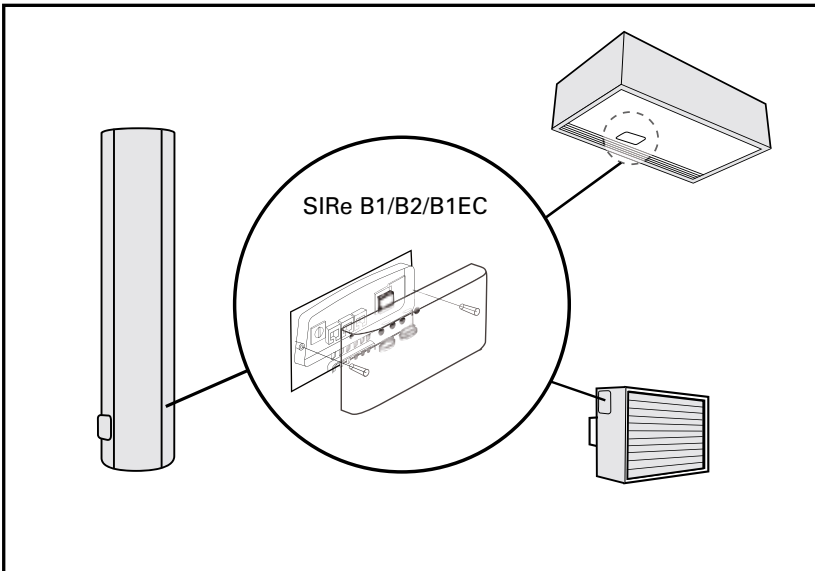
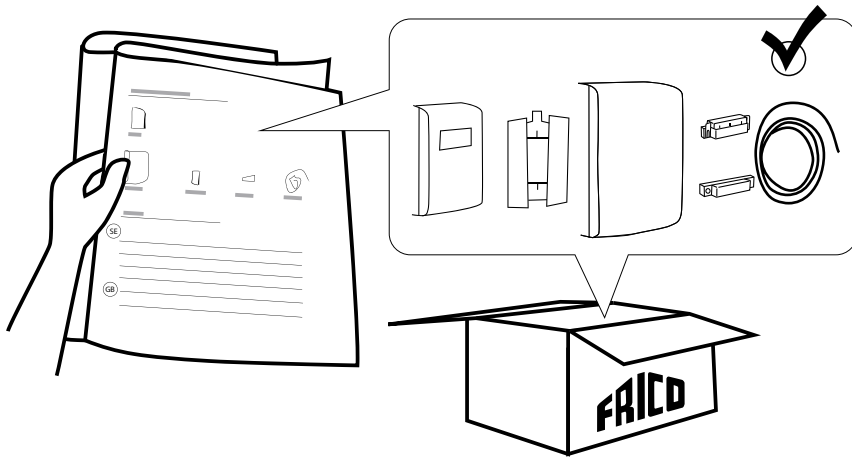

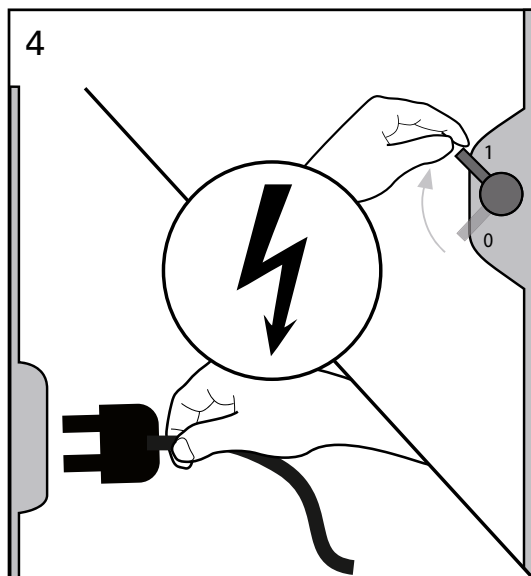
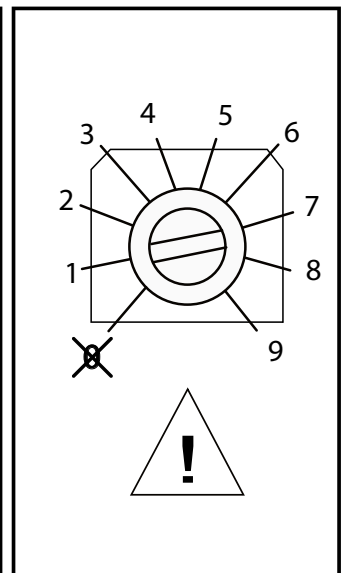
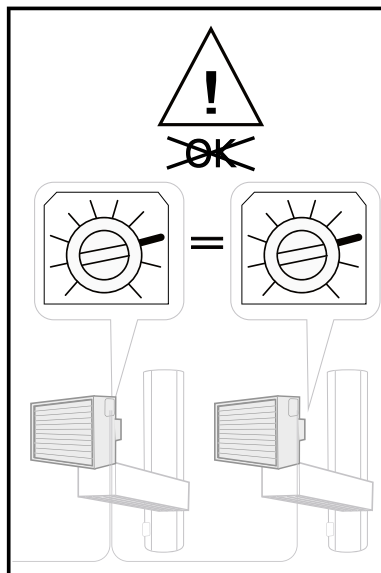
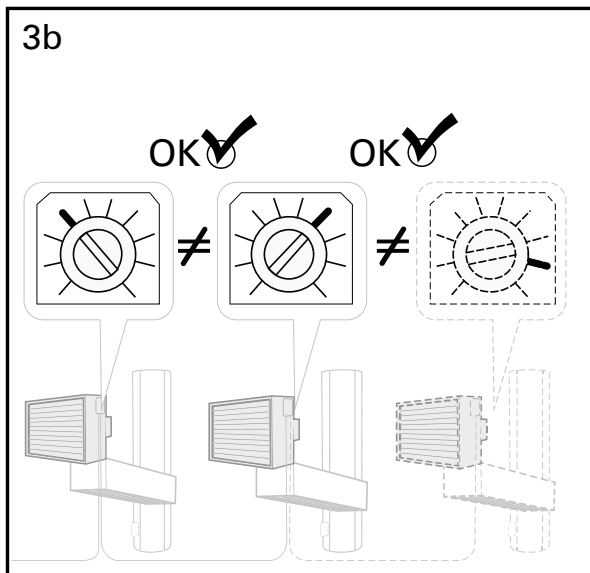
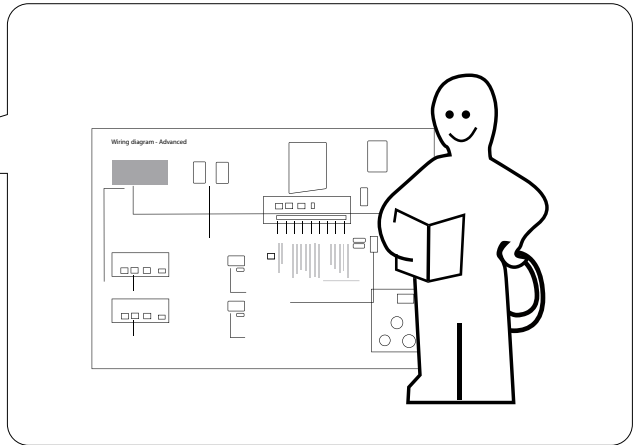
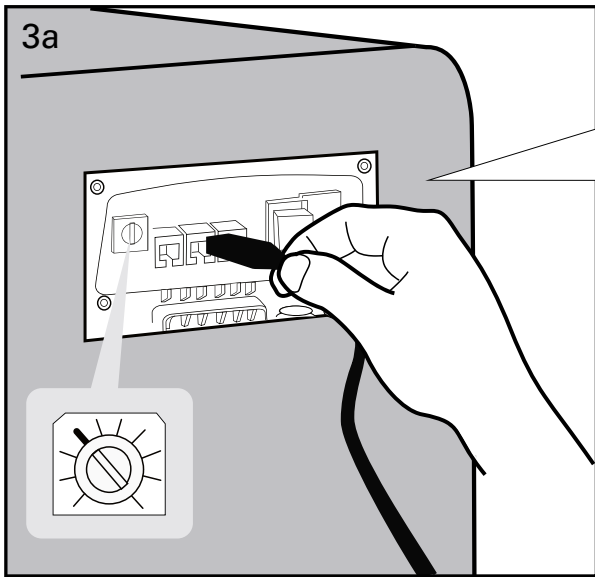

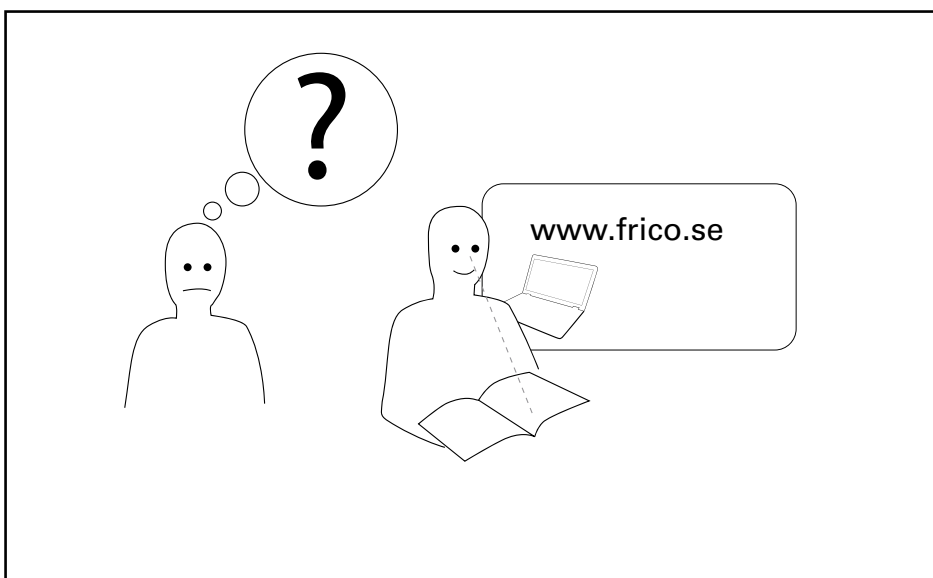
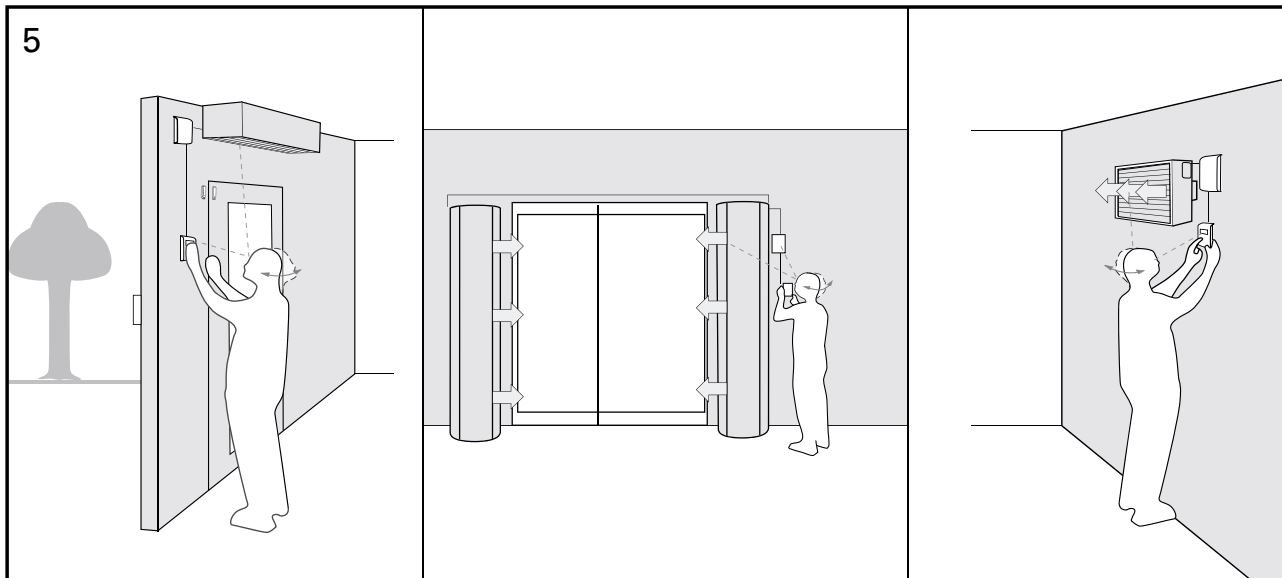

UA1Y	UA1Z
Svenska	Polski
Norsk	Русский
English	English
Deutsch	Čeština
Français	Slovenčina
Italiano	Türkçe
Español	Português
Nederlands	Română
Suomi	Magyar
Dansk	Українська

SIReAA SIReFA

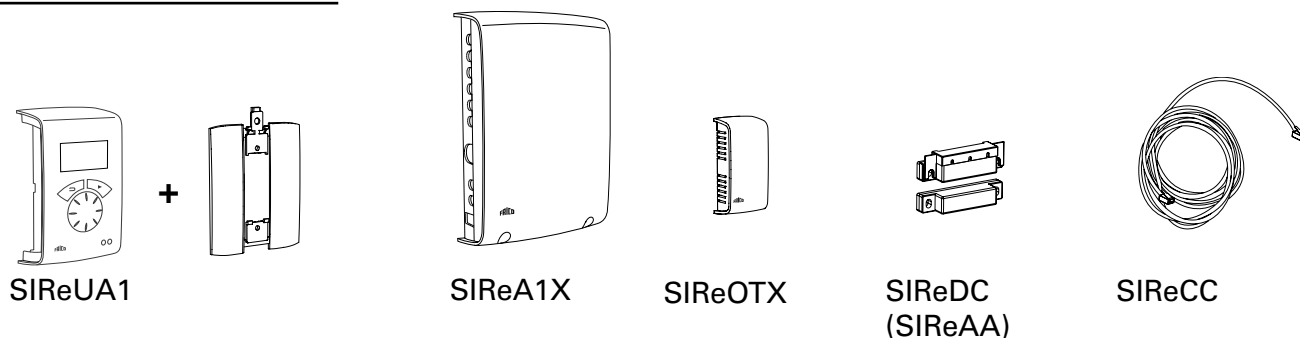

SE

Bestandsdelar

Typ	Beskrivning	HxBxD [mm]	L [m]
SIReUA1	Kontrollenhet, med inbyggd rumssensor, Dostäckerlock	120x70x35	
SIReA1X	Styrkort HUB Advanced	202x139x50	
SIReOTX	Utetemperaturgivare	70x33x23	10
SIReDC	Magnetisk dörrkontakt		
SIReCC603	Modularkabel RJ12 (6/6)		3
SIReCC605	Modularkabel RJ12 (6/6)		5

GB

Constituent parts

Type	Description	HxWxD [mm]	L [m]
SIReUA1	Control unit, with internal room sensor, Wall unit cover	120x70x35	
SIReA1X	PC Board HUB Advanced	202x139x50	
SIReOTX	Outdoor temperature sensor	70x33x23	10
SIReDC	Magnetic door contact		
SIReCC603	Modular cable RJ12 (6/6)		3
SIReCC605	Modular cable RJ12 (6/6)		5

DE

Bestandteile

Typ	Beschreibung	HxBxT [mm]	L [m]
SIReUA1	Kontrolleinheit, mit Innenraumfühler, Wandgerät-Abdeckung	120x70x35	
SIReA1X	PC Board Hub Erweitert	202x139x50	
SIReOTX	Außentemperatursensor	70x33x23	10
SIReDC	Magnetischer Türkontakt		
SIReCC603	Modulares Kabel RJ12 (6/6)		3
SIReCC605	Modulares Kabel RJ12 (6/6)		5

FR

Pièces constitutives

Type	Désignation	HxLxP [mm]	L [m]
SIReUA1	Unité de contrôle, Protection de boîtier mural	120x70x35	
SIReA1X	Carte électronique HUB Advanced	202x139x50	
SIReOTX	Sonde de température extérieure	70x33x23	10
SIReDC	Contact de position magnétique		
SIReCC603	Câble modulaire RJ12 (6/6)		3
SIReCC605	Câble modulaire RJ12 (6/6)		5

ES

Componentes

Tipo	Descripción	HxWxD [mm]	L [m]
SIReUA1	Unidad de control, Con sensor de ambiente interno, Tapa para unidad de pared	120x70x35	
SIReA1X	Tarjeta hub pc advanced	202x139x50	
SIReOTX	Sensor de temperatura exterior	70x33x23	10
SIReDC	Contacto de puerta		
SIReCC603	Cable modular Rj12 (6/6)		3
SIReCC605	Cable modular Rj12 (6/6)		5

IT

Componenti

Tipo	Descrizione	HxLxP [mm]	L [m]
SIReUA1	Unità di controllo, con sensore interno della temperatura ambiente, copertura per unità a parete	120x70x35	
SIReA1X	HUB scheda PC Advanced	202x139x50	
SIReOTX	Sensore della temperatura esterna	70x33x23	10
SIReDC	Contatto magnetica per porta		
SIReCC603	Cavo modulare RJ12 (6/6)		3
SIReCC605	Cavo modulare RJ12 (6/6)		5

NL

Onderdelen

Typ	Omschrijving	HxWxD [mm]	L [m]
SIReUA1	Regelunit, met interne kamersensor, kap wandgemonteerde unit	120x70x35	
SIReA1X	Hub printplaat advanced	202x139x50	
SIReOTX	Sensor buitentemperatuur	70x33x23	10
SIReDC	Deurcontact		
SIReCC603	Modulaire kabel Rj12 (6/6)		3
SIReCC605	Modulaire kabel Rj12 (6/6)		5

NO

Bestanddeler

Type	Beskrivelse	HxBxD [mm]	L [m]
SIReUA1	Kontrollenhet, med intern romføler, deksel til veggenhet	120x70x35	
SIReA1X	PC Board HUB Advanced	202x139x50	
SIReOTX	Utetemperaturføler	70x33x23	10
SIReDC	Dørkontakt		
SIReCC603	Modulærkabel RJ12 (6/6)		3
SIReCC605	Modulærkabel RJ12 (6/6)		5

PL

Części składowe

Typ	Opis	HxWxD [mm]	L [m]
SIReUA1	Sterownik z wewnętrznym czujnikiem temperatury pomieszczenia i pokrywą ścienną	120x70x35	
SIReA1X	Karta PC HUB Advanced	202x139x50	
SIReOTX	Zewnętrzny czujnik temperatury	70x33x23	10
SIReDC	Czujnik drzwiowy		
SIReCC603	Kabel modułowy Rj12 (6/6)		3
SIReCC605	Kabel modułowy Rj12 (6/6)		5

RU

Комплекующие элементы

Модель	Описание	Габариты [мм]	L [м]
SIReUA1	Панель управления, с датчиком комнатной температуры, с накладкой на стену	120x70x35	
SIReA1X	Управляющая плата системы Профи	202x139x50	
SIReOTX	Датчик Наружной Температуры	70x33x23	10
SIReDC	Дверной Контакт		
SIReCC603	Кабель С Разъемами RJ12 (6/6)		3
SIReCC605	Кабель С Разъемами RJ12 (6/6)		5

FI

Osat

Malli	Kuvaus	KxLxS [mm]	P [m]
SIReUA1	Ohjausyksikkö sisäisellä huoneanturilla, pinta-asennus	120x70x35	
SIReA1X	Piirikortti HUB Advanced	202x139x50	
SIReOTX	Ulkolämpötila-anturi	70x33x23	10
SIReDC	Ovikosketin		
SIReCC603	Modulaarikaapeli RJ12 (6/6)		3
SIReCC605	Modulaarikaapeli RJ12 (6/6)		5

SIRe Advanced

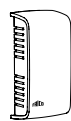

SIReRTX

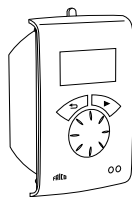

SIReUR



SIReCJ4



SIReCJ6

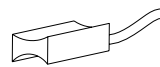

SIReWTA

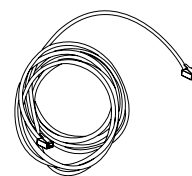

SIReCC

SE

Tillval

Typ	RSK-nr	E-nr	Beskrivning	HxBxD [mm]	L [m]
SIReRTX	673 09 22	87 510 12	Extern rumstemperaturgivare	70x33x23	10
SIReUR*	673 09 21	87 510 11	Kit för infällt montage	114x70x50	
SIReCJ4	673 09 70	87 510 33	Skarvstycke för två st. RJ11 (4/4)		
SIReCJ6	673 09 71	87 510 34	Skarvstycke för två st. RJ12 (6/6)		
SIReWTA	673 09 69		Returvattentemperaturgivare RJ11 (4/4)		3
SIReCC603	673 09 23	87 510 13	Modularkabel RJ12 (6/6)		3
SIReCC605	673 09 24	87 510 14	Modularkabel RJ12 (6/6)		5
SIReCC610	673 09 25	87 510 15	Modularkabel RJ12 (6/6)		10
SIReCC615	673 09 26	87 510 16	Modularkabel RJ12 (6/6)		15
SIReCC640	673 18 79	87 510 45	Modularkabel RJ12 (6/6)		40
SIReCC403	673 09 27	87 510 17	Modularkabel RJ11 (4/4)		3
SIReCC405	673 09 28	87 510 18	Modularkabel RJ11 (4/4)		5
SIReCC410	673 09 29	87 510 19	Modularkabel RJ11 (4/4)		10
SIReCC415	673 09 30	87 510 20	Modularkabel RJ11 (4/4)		15

*) Se separat manual.

GB

Option

Type	Description	HxWxD [mm]	L [m]
SIReRTX	External room temperature sensor	70x33x23	10
SIReUR*	Kit for recessed installation	114x70x50	
SIReCJ4	Joint piece for two pcs. RJ11 (4/4)		
SIReCJ6	Joint piece for two pcs. RJ12 (6/6)		
SIReWTA	Return water sensor RJ11(4/4)		3
SIReCC603	Modular cable RJ12 (6/6)		3
SIReCC605	Modular cable RJ12 (6/6)		5
SIReCC610	Modular cable RJ12 (6/6)		10
SIReCC615	Modular cable RJ12 (6/6)		15
SIReCC640	Modular cable RJ12 (6/6)		40
SIReCC403	Modular cable RJ11 (4/4)		3
SIReCC405	Modular cable RJ11 (4/4)		5
SIReCC410	Modular cable RJ11 (4/4)		10
SIReCC415	Modular cable RJ11 (4/4)		15

*) See separate manual.

DE

Optional

Typ	Beschreibung	HxBxT [mm]	L [m]
SIReRTX	Externer Raumtemperatursensor	70x33x23	10
SIReUR*	Kit für versenkte Installation	114x70x50	
SIReCJ4	Verbindungsstück für zwei Teile RJ11 (4/4)		
SIReCJ6	Verbindungsstück für zwei Teile RJ12 (6/6)		
SIReWTA	Sensor Rücklaufwassertempertur RJ11 (4/4)		3
SIReCC603	Modulares Kabel RJ12 (6/6)		3
SIReCC605	Modulares Kabel RJ12 (6/6)		5
SIReCC610	Modulares Kabel RJ12 (6/6)		10
SIReCC615	Modulares Kabel RJ12 (6/6)		15
SIReCC640	Modulares Kabel RJ12 (6/6)		40
SIReCC403	Modulares Kabel RJ11 (4/4)		3
SIReCC405	Modulares Kabel RJ11 (4/4)		5
SIReCC410	Modulares Kabel RJ11 (4/4)		10
SIReCC415	Modulares Kabel RJ11 (4/4)		15

*) Siehe separates Handbuch.

FR

Option

Type	Désignation	HxLxP [mm]	L [m]
SIReRTX	Sonde de température ambiante déportée	70x33x23	10
SIReUR*	Kit pour installation encastrée	114x70x50	
SIReCJ4	Pièce de jonction pour deux pcs. RJ11 (4/4)		
SIReCJ6	Pièce de jonction pour deux pcs. RJ12 (6/6)		
SIReWTA	Sonde de retour d'eau RJ11(4/4)		3
SIReCC603	Câble modulaire RJ12 (6/6)		3
SIReCC605	Câble modulaire RJ12 (6/6)		5
SIReCC610	Câble modulaire RJ12 (6/6)		10
SIReCC615	Câble modulaire RJ12 (6/6)		15
SIReCC640	Câble modulaire RJ12 (6/6)		40
SIReCC403	Câble modulaire RJ11 (4/4)		3
SIReCC405	Câble modulaire RJ11 (4/4)		5
SIReCC410	Câble modulaire RJ11 (4/4)		10
SIReCC415	Câble modulaire RJ11 (4/4)		15

*) Consultez le manuel associé.

ES

Opciones

Tipo	Descrizione	HxWxD [mm]	L [m]
SIReRTX	Sensor de temperatura ambiente externo	70x33x23	10
SIReUR*	Kit para instalación empotrada	114x70x50	
SIReCJ4	Pieza de unión RJ11 (4/4)		
SIReCJ6	Pieza de unión RJ12 (6/6)		
SIReWTA	Sensor de agua de retorno RJ11(4/4)		3
SIReCC603	Cable modular RJ12 (6/6)		3
SIReCC605	Cable modular RJ12 (6/6)		5
SIReCC610	Cable modular RJ12 (6/6)		10
SIReCC615	Cable modular RJ12 (6/6)		15
SIReCC640	Cable modular RJ12 (6/6)		40
SIReCC403	Cable modular RJ11 (4/4)		3
SIReCC405	Cable modular RJ11 (4/4)		5
SIReCC410	Cable modular RJ11 (4/4)		10
SIReCC415	Cable modular RJ11 (4/4)		15

*) Consulte el manual correspondiente.

IT

Opzione

Typo	Descrizione	HxLxP [mm]	L [m]
SIReRTX	Sensore esterno della temperatura ambiente	70x33x23	10
SIReUR*	Kit per installazione incassata	114x70x50	
SIReCJ4	Elemento di giunzione RJ11 (4/4)		
SIReCJ6	Elemento di giunzione RJ12 (6/6)		
SIReWTA	Sensor temperatura RJ11 (4/4)		3
SIReCC603	Cavo modulare RJ12 (6/6)		3
SIReCC605	Cavo modulare RJ12 (6/6)		5
SIReCC610	Cavo modulare RJ12 (6/6)		10
SIReCC615	Cavo modulare RJ12 (6/6)		15
SIReCC640	Cavo modulare RJ12 (6/6)		40
SIReCC403	Cavo modulare RJ11(4/4)		3
SIReCC405	Cavo modulare RJ11(4/4)		5
SIReCC410	Cavo modulare RJ11 (4/4)		10
SIReCC415	Cavo modulare RJ11(4/4)		15

*) Vedere il manuale specifico.

NL

Optie

Typ	Omschrijving	HxWxD [mm]	L [m]
SIReRTX	External room temperature sensor	70x33x23	10
SIReUR*	Kit for recessed installation	114x70x50	
SIReCJ4	Koppelstuk voor twee stuks RJ11 (4/4)		
SIReCJ6	Koppelstuk voor twee stuks RJ12 (6/6)		
SIReWTA	Klemsensor RJ11(4/4)		3
SIReCC603	Modulaire kabel RJ12 (6/6)		3
SIReCC605	Modulaire kabel RJ12 (6/6)		5
SIReCC610	Modulaire kabel RJ12 (6/6)		10
SIReCC615	Modulaire kabel RJ12 (6/6)		15
SIReCC640	Modulaire kabel RJ12 (6/6)		40
SIReCC403	Modulaire kabel RJ11 (4/4)		3
SIReCC405	Modulaire kabel RJ11 (4/4)		5
SIReCC410	Modulaire kabel RJ11 (4/4)		10
SIReCC415	Modulaire kabel RJ11 (4/4)		15

*) Zie aparte handleiding.

NO

Ekstraustyr

Type	NRF-no.	EL-no.	Beskrivelse	HxBxD [mm]	L [m]
SIReRTX	85 022 94	54 910 01	Ekstern romtemperaturføler	70x33x23	10
SIReUR*	85 022 93	49 325 00	Sett for innfelt montering	114x70x50	
SIReCJ4		54 910 02	Skjøtestykke RJ11 (4/4)		
SIReCJ6			Skjøtestykke RJ12 (6/6)		
SIReWTA			Temperaturføler RJ11(4/4)		3
SIReCC603	85 022 95	54 329 01	Modulærkabel RJ12 (6/6)		3
SIReCC605	85 022 96	54 329 02	Modulærkabel RJ12 (6/6)		5
SIReCC610	85 022 97	54 329 03	Modulærkabel RJ12 (6/6)		10
SIReCC615	85 022 98	54 329 04	Modulærkabel RJ12 (6/6)		15
SIReCC640			Modulærkabel RJ12 (6/6)		40
SIReCC403	85 022 99	54 329 05	Modulærkabel RJ11 (4/4)		3
SIReCC405	85 023 01	54 329 06	Modulærkabel RJ11 (4/4)		5
SIReCC410	85 023 02	54 329 07	Modulærkabel RJ11 (4/4)		10
SIReCC415	85 023 03	54 329 08	Modulærkabel RJ11 (4/4)		15

*) Se egen håndbok.

PL

Opcja

Typ	Opis	HxWxD [mm]	L [m]
SIReRTX	Zewnętrzny czujnik temperatury pomieszczenia	70x33x23	10
SIReUR*	Zestaw do zabudowy	114x70x50	
SIReCJ4	Połączenie. RJ11 (4/4)		
SIReCJ6	Połączenie. RJ12 (6/6)		
SIReWTA	Przylgowy czujnik wody powrotnej RJ11(4/4)		3
SIReCC603	Kabel modułowy RJ12 (6/6)		3
SIReCC605	Kabel modułowy RJ12 (6/6)		5
SIReCC610	Kabel modułowy RJ12 (6/6)		10
SIReCC615	Kabel modułowy RJ12 (6/6)		15
SIReCC640	Kabel modułowy RJ12 (6/6)		40
SIReCC403	Kabel modułowy RJ11 (4/4)		3
SIReCC405	Kabel modułowy RJ11 (4/4)		5
SIReCC410	Kabel modułowy RJ11 (4/4)		10
SIReCC415	Kabel modułowy RJ11 (4/4)		15

*) Patrz oddzielna instrukcja.

RU

Принадлежности

Модель	Описание	Габариты [мм]	L [м]
SIReRTX	Внешний датчик комнатной температуры	70x33x23	10
SIReUR*	Блок управления для установки в стену	114x70x50	
SIReCJ4	Разъем RJ11 (4/4)		
SIReCJ6	Разъем RJ12 (6/6)		
SIReWTA	датчик температуры обратной воды RJ11(4/4)		3
SIReCC603	Кабель с разъемами RJ12 (6/6)		3
SIReCC605	Кабель с разъемами RJ12 (6/6)		5
SIReCC610	Кабель с разъемами RJ12 (6/6)		10
SIReCC615	Кабель с разъемами RJ12 (6/6)		15
SIReCC640	Кабель с разъемами RJ12 (6/6)		40
SIReCC403	Кабель с разъемами RJ11 (4/4)		3
SIReCC405	Кабель с разъемами RJ11 (4/4)		5
SIReCC410	Кабель с разъемами RJ11 (4/4)		10
SIReCC415	Кабель с разъемами RJ11 (4/4)		15

*) См. отдельную инструкцию.

FI

Vaihtoehdot

Malli	Kuvaus	KxLxS [mm]	P [m]
SIReRTX	Ulkoinen huonelämpötila-anturi	70x33x23	10
SIReUR*	Uppoasennussarja	114x70x50	
SIReCJ4	Jatkoliitin 2xRJ11(4/4)		
SIReCJ6	Jatkoliitin 2xRJ12(6/6)		
SIReWTA	Pinta-anturi RJ11 (4/4)		3
SIReCC603	Modulaarikaapeli RJ12 (6/6)		3
SIReCC605	Modulaarikaapeli RJ12 (6/6)		5
SIReCC610	Modulaarikaapeli RJ12 (6/6)		10
SIReCC615	Modulaarikaapeli RJ12 (6/6)		15
SIReCC640	Modulaarikaapeli RJ12 (6/6)		40
SIReCC403	Modulaarikaapeli RJ11 (4/4)		3
SIReCC405	Modulaarikaapeli RJ11 (4/4)		5
SIReCC410	Modulaarikaapeli RJ11 (4/4)		10
SIReCC415	Modulaarikaapeli RJ11 (4/4)		15

*) Katso erillinen käyttöohje.

VLP

VKF



TAC

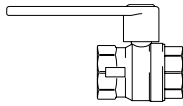

AV

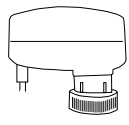

SDM24

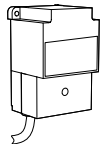

ST23024

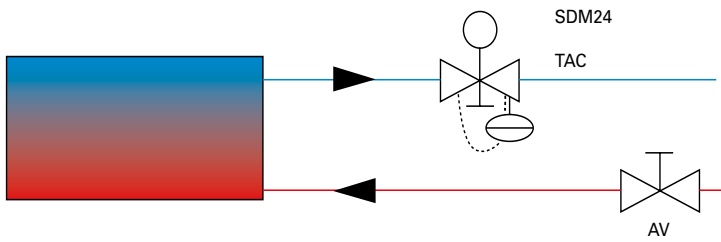

VMT

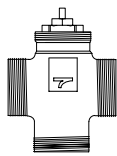

TRVS

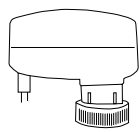

SDM24

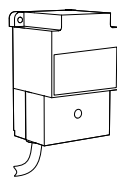

ST23024

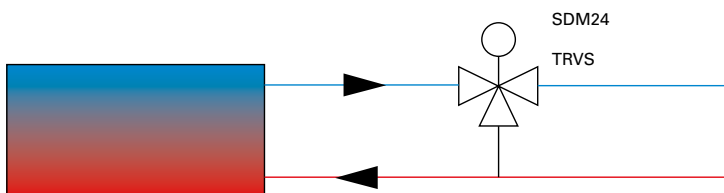

SE

Vattenreglering - ventilsystem*

Typ	RSK-nr	Beskrivning	Anslutning
VLP15LF	673 09 47	Tryckoberoende och modulerande	DN15
VLP15NF	673 09 48	Tryckoberoende och modulerande	DN15
VLP20	673 09 49	Tryckoberoende och modulerande	DN20
VLP25	673 09 50	Tryckoberoende och modulerande	DN25
VLP32	670 45 34	Tryckoberoende och modulerande	DN32

*) Se separata manualer.

GB

Water control - valve system*

Type	Description	Connection
VLP15LF	Pressure independent and modulating	DN15
VLP15NF	Pressure independent and modulating	DN15
VLP20	Pressure independent and modulating	DN20
VLP25	Pressure independent and modulating	DN25
VLP32	Pressure independent and modulating	DN32
VMT15	Three way valve and modulating actuator	DN15
VMT20	Three way valve and modulating actuator	DN20
VMT25	Three way valve and modulating actuator	DN25

*) See separate manuals.

DE

Wasserregelung - Ventilsystem*

Typ	Beschreibung	Anschluss
VLP15LF	Druckunabhängig und modulierend	DN15
VLP15NF	Druckunabhängig und modulierend	DN15
VLP20	Druckunabhängig und modulierend	DN20
VLP25	Druckunabhängig und modulierend	DN25
VLP32	Druckunabhängig und modulierend	DN32
VMT15	3-Wege-Regelventil mit modulierendem Stellmotor	DN15
VMT20	3-Wege-Regelventil mit modulierendem Stellmotor	DN20
VMT25	3-Wege-Regelventil mit modulierendem Stellmotor	DN25

*) Siehe separates Handbuch.

FR

Régulation hydraulique - système de vannes*

Type	Désignation	Raccordement
VLP15LF	Modulable et indépendant de la pression	DN15
VLP15NF	Modulable et indépendant de la pression	DN15
VLP20	Modulable et indépendant de la pression	DN20
VLP25	Modulable et indépendant de la pression	DN25
VLP32	Modulable et indépendant de la pression	DN32
VMT15	Vanne de commande 3 voies, électrovanne modulable	DN15
VMT20	Vanne de commande 3 voies, électrovanne modulable	DN20
VMT25	Vanne de commande 3 voies, électrovanne modulable	DN25

*) Consultez les manuels associés.

ES

Control del agua - sistema de válvulas*

Tipo	Descripción	Conexión
VLP15LF	Juego de válvulas independientes de la presión y moduladoras	DN15
VLP15NF	Juego de válvulas independientes de la presión y moduladoras	DN15
VLP20	Juego de válvulas independientes de la presión y moduladoras	DN20
VLP25	Juego de válvulas independientes de la presión y moduladoras	DN25
VLP32	Juego de válvulas independientes de la presión y moduladoras	DN32
VMT15	Válvula reguladora de 3 vías con actuador modulante.	DN15
VMT20	Válvula reguladora de 3 vías con actuador modulante.	DN20
VMT25	Válvula reguladora de 3 vías con actuador modulante.	DN25

*) Consulte el manual correspondiente.

IT

Controllo dell'acqua - sistema di valvole*

Tipo	Descrizione	Collegamento
VLP15LF	Pressione indipendente e modulante	DN15
VLP15NF	Pressione indipendente e modulante	DN15
VLP20	Pressione indipendente e modulante	DN20
VLP25	Pressione indipendente e modulante	DN25
VLP32	Pressione indipendente e modulante	DN32
VMT	Valvola a 3 vie e attuatore modulante	DN15
VMT	Valvola a 3 vie e attuatore modulante	DN20
VMT	Valvola a 3 vie e attuatore modulante	DN25

*) Vedere i manuali specifici.

NL

Waterregeling - kleppensysteem*

Type	Omschrijving	Aansluiting
VLP15LF	Drukafhankelijke regelkleppenset	DN15
VLP15NF	Drukafhankelijke regelkleppenset	DN15
VLP20	Drukafhankelijke regelkleppenset	DN20
VLP25	Drukafhankelijke regelkleppenset	DN25
VLP32	Drukafhankelijke regelkleppenset	DN32
VMT15	Driewegventiel en modulerend magneetventiel.	DN15
VMT20	Driewegventiel en modulerend magneetventiel.	DN20
VMT25	Driewegventiel en modulerend magneetventiel.	DN25

*) Zie aparte handleidingen

NO

Vannregulering - ventilsystem*

Type	Beskrivelse	Tilkobling
VLP15LF	Trykkuavhengig og modulerende	DN15
VLP15NF	Trykkuavhengig og modulerende	DN15
VLP20	Trykkuavhengig og modulerende	DN20
VLP25	Trykkuavhengig og modulerende	DN25
VLP32	Trykkuavhengig og modulerende	DN32

*) Se egne håndbøker.

PL

Regulacja przepływu wody – zestaw zaworów*

Type	Opis	Złącze
VLP15LF	Niezależny od ciśnienia	DN15
VLP15NF	Niezależny od ciśnienia	DN15
VLP20	Niezależny od ciśnienia	DN20
VLP25	Niezależny od ciśnienia	DN25
VLP32	Niezależny od ciśnienia	DN32
VMT15	Zawór 3-drogowy i siłownik z modulacją	DN15
VMT20	Zawór 3-drogowy i siłownik z modulacją	DN20
VMT25	Zawór 3-drogowy i siłownik z modulacją	DN25

*) Patrz oddzielne instrukcje.

RU

Регулировка расхода воды - комплект клапанов*

Модель	Описание	Соединение
VLP15LF	комплект клапанов пропорционального регулирования с функцией постоянного расхода	DN15
VLP15NF	комплект клапанов пропорционального регулирования с функцией постоянного расхода	DN15
VLP20	комплект клапанов пропорционального регулирования с функцией постоянного расхода	DN20
VLP25	комплект клапанов пропорционального регулирования с функцией постоянного расхода	DN25
VLP32	комплект клапанов пропорционального регулирования с функцией постоянного расхода	DN32
VMT15	Трехходовой клапан с пропорциональным приводом	DN15
VMT20	Трехходовой клапан с пропорциональным приводом	DN20
VMT25	Трехходовой клапан с пропорциональным приводом	DN25

*) смотрите отдельную инструкцию.

FI

Veden säätö - venttiilisarja*

Malli	Kuvaus	KytKentä
VLP15LF	Painevakioitu ja moduloiva venttiilisarja	DN15
VLP15NF	Painevakioitu ja moduloiva venttiilisarja	DN15
VLP20	Painevakioitu ja moduloiva venttiilisarja	DN20
VLP25	Painevakioitu ja moduloiva venttiilisarja	DN25
VLP32	Painevakioitu ja moduloiva venttiilisarja	DN32

*) Katso erillinen käyttöohje.

Quick guide/Start up

1. Check that all constituent parts are present (see section Constituent parts).
2. Mount and connect all units and components and where applicable accessories (e.g. actuator), see wiring diagram. When several units are connected set a unique ID for each unit (1-9) which is set in the ID selector of the SIReB1/B2/B1EC.

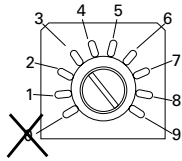
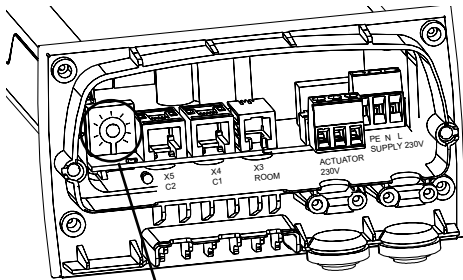

Each unit should have a unique ID on its SIReB1/B2/B1EC card.

3. Power up all units.
4. The start-up wizard runs and basic settings are made. The system check identifies connected components in the system and the function test shows if all units are correctly connected.

Operation without control unit

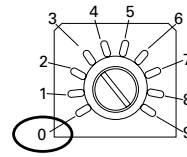

To run the unit temporarily without external control select mode 0.

SDM24

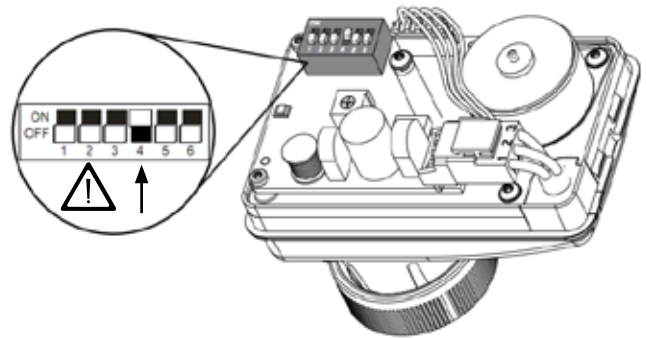

For actuator SDM24 (included in the valve kit) to work with SIRe the setting should be as follows:



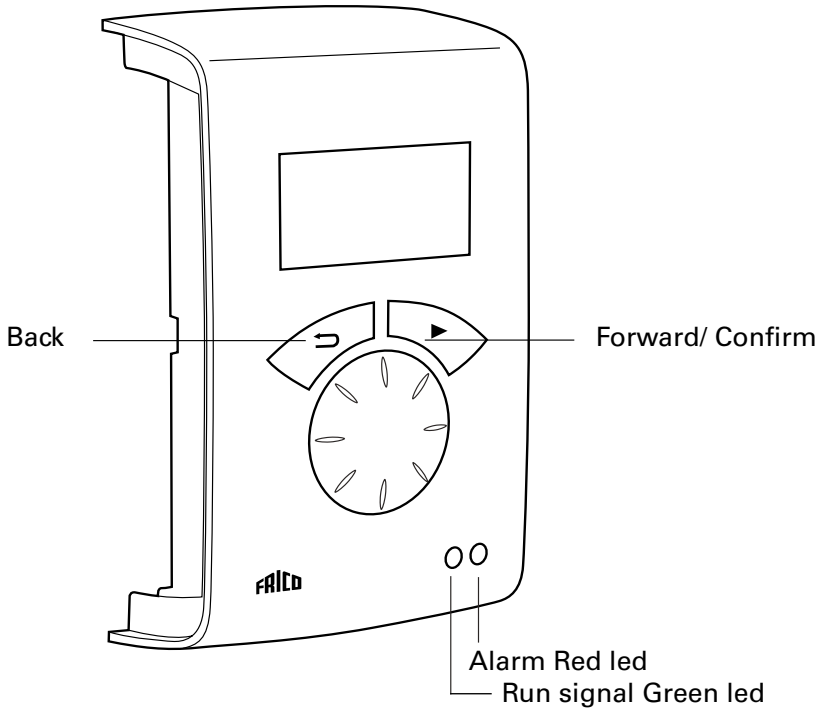

Control unit SIReUA1

Overview

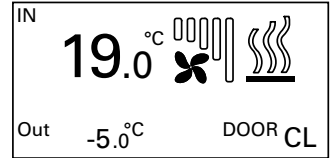

Air curtains   
SIRe AA



Fan heaters  
SIRe FA
Auto

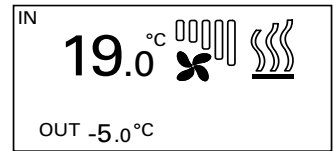

Manual mode

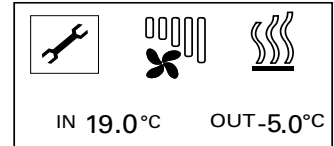

Fan speed step



Heating step



Week program
Day



Week program
Night

OFF

Week program
Out of operation



Manual operation (SIReFA)

Main menu

Current settings

Current set values.

Temperature settings

Day/night temperature. The night temperature is only valid when the week program is activated.

Installer menu

Password 1932

Installer status screen

Current settings and functions.

Week program

Activate week program, check, change, add or erase program.

Fan settings

Fan control and over run functions.

Heating settings

Block heat regarding the outdoor temperature, activate Eco mode, set point difference open door, (calibrating sensors), activate return water temperature sensor (only valid for water supplied units and SIReWTA is required)

Fan control

Maximum fan speed and fan speed when the door is closed. Fan speed when the door is closed is only valid when using SIReAA.

System on/off

Safety features are still active when the system is switched off.

Filter guard settings

Activate filter guard and set service interval.

External control (BMS)

External on/off, fan and heating control 0-10V, Gateway (modbus). See "Connecting external control".

General settings

Language, time, date, function test, manual system check and factory reset.

Support menu

The support menu is password protected and is used for support in contact with Frico or authorised installer.

Alarm and error codes

Reset alarm

Note! Before resetting, check that the fault is rectified and there is nothing to prevent the unit from being recommissioned.

Press ► and select reset alarm.

At the first start up alarm and error codes can occur, these will usually be reset without actions.

Power failure

Note! A power loss longer than 7 days may require an adjustment of time and date. The week program is affected if the clock is not correctly set.

Complete manual see www.frico.se

Table - Alarm

Error code		Cause	Action
A1	Motor alarm	Thermal contact has deployed. One or more motors are overheated.	Check that nothing is obstructing the unit's air intake and exhaust. When the overheated motor has cooled the thermal switch shuts again and the alarm can be reset. At repeated alarms, check the motors, replace damaged motors.
		Missing link on motor protection on SIReB1/B2/B1EC.	For units having built-in thermal protection but without external connection, the motor protection terminals must be linked.
		Unit won't start.	For units having built-in thermal protection but without external connection, the motor protection terminals must be linked.
—		Unit only starts on high speed.	Check motor and transformer connection terminal on the SIReB1/B2/B1EC-pc board.
A2	Over heating alarm	The temperature in the unit has exceeded the alarm limit for overheating. (Only units with internal temperature sensor)	Check that nothing is obstructing the unit's air intake and exhaust.
			Check function of the contactors (E), Check function of actuator and valve, flow temperature and bypass settings (W).
			Check internal temperature sensor, measure resistance, 47kOhm at 25°C.
A3	Frost protection alarm	The temperature in the unit has fallen below the alarm limit for frost protection (only water heated units with internal temperature sensor and/ or return water temperature sensor SIReWTA).	Check the function of the actuator, valve and bypass settings.
			Check the temperature and flow of the hot water supply.
			In event of an alarm there is a risk that the coil is damaged, check carefully for leakage and replace the water heating coil if damaged.
A4	Filter alarm	Fixed run time before filter alarm has been reached.	Replace or clean the filter, if necessary adjust the fixed time based on how dirty the filter was and reset the alarm.
		The external filter guard has been activated.	Replace or clean the filter, if necessary adjust settings of the filter guard based on how dirty the filter was and reset the alarm.
A5	External alarm	External alarm input (terminal 9-10) on SIReA1X/SIReC1X has been activated	Check the external alarm.

Table - Error codes

Error code	Cause	Action	
E1	Communication error	SIReB1/B2/B1EC (internal pc-board) do not communicate.	Try to reset the alarm. Check connections, modular cables and terminals, between all units and components. Systematically shift position of communication cables to identify a broken terminal or cables.
		ID is set to 0 (Unit is running continuously).	Set an ID, run a Manual system check.
		Cables are not original.	Make sure communication cables are correct (Frico original cables has a circuit diagram indicating how the contacts shall be crimped on to the cable.)
		The unit won't start.	In multiple unit system, check that you have 230VAC to all units.
			In <i>Installer menu - Installer status screen</i> , check that all units ID are listed and that no extra units are listed. When all units are powered up run a Manual system check.
			Disconnect power, set ID=0 and reconnect power to test the B1/B2/B1EC pc-board.
Perform a factory reset and reboot the system (disconnect/ reconnect power).			
Visual damage to SIReB1/B2/B1EC.	Hardware failure - replace the SIReB1/B2/B1EC pc-board. Contact Frico technical support.		
E2	ID Error	Two or more SIReB1/B2/B1EC have the same ID.	Try to reset the alarm. Make sure all units have different ID-settings and perform a Manual system check.
E3	Program error (No program)	One or more SIReB1/B2/B1EC do not have program.	Try to reset the alarm. Disconnect power, set ID=0 and reconnect power to test the B1/B2/B1EC pc-board - result? If the unit is running act as if it was an E1 Communication error. If it is not running, contact Frico technical support.
E4	Room sensor error	Fault on or missing external room sensor SIReRTX connected to SIReB1/B2/B1EC.	Try to reset the alarm. Check connections and cable. False errors can occur in conjunction with communication error, check that all other alarms have been reset. Measure resistance, 47kOhm at 25°C.
		Wrong temperature is displayed in SIReUA1.	If the sensor intentionally has been removed, run a Manual system check to exclude it from the system.
E6	Return water temp. sensor error.	Fault on or missing Return water sensor SIReWTA connected to SIReB1/B2/B1EC.	If a return water sensor (SIReWTA) is connected but not activated, the system will interpret that value as a room temperature value, activate return water sensor. When SIReWTA is used, SIReRTX shall be connected to the SIReA1X.
			Try to reset the alarm. Check connections and cable. False errors can occur in conjunction with communication error, check that all other alarms have been reset. Measure resistance, 47kOhm at 25°C.
			If the sensor intentionally has been removed, run a Manual system check to exclude it from the system.
		Wrong temperature is displayed in SIReUA1.	Return water temperature sensor is activated with a SIReRTX-sensor connected - In the menu, disable return water temperature sensor.

E7	Return water temp. sensor error.	Fault on or missing, mandatory Return water sensor SIReWTA connected to SIReB1/B2/B1EC.	Try to reset the alarm. Check connections and cable. False errors can occur in conjunction with communication error, check that all other alarms have been reset. Measure resistance, 47kOhm at 25°C.
		Wrong temperature is displayed in SIReUA1.	Confirm that WTA is connected to the SIReB1/B2/B1EC and securely fastened to the return water pipe and compare with what the actual temperature is.
			SIReRTX-sensor must not be connected to SIReB1/B2/B1EC when the intention is to use return water sensor. When SIReWTA is used, SIReRTX shall be connected to the SIReA1X
E8	Internal sensor Error	Fault on or missing internal temperature sensor, SIReIT, connected to SIReB1/B2/B1EC.	Try to reset the alarm. Check connections and cable. False errors can occur in conjunction with communication error, check that all other alarms have been reset. Measure resistance, 47kOhm at 25°C.
E10	Program error (different programs)	Two or more SIReB1/B2/B1EC in the system have different programs.	Try to reset the alarm. SIRe can control different types of units, e.g. Fan heaters or air curtains, water or electrical units, but they cannot be combined. The only exception is ambient air curtains in combination with either electrical or water heated units of the same model. Check the datalabels of your units and contact Frico technical support.
E12	Room sensor error	Fault on or missing external room sensor, SIReRTX connected to SIReA1X/C1X.	Try to reset the alarm. Check connections and cable. False errors can occur in conjunction with communication error, check that all other alarms have been reset. Measure resistance, 47kOhm at 25°C.
E14	Outdoor sensor error	Fault on or missing, mandatory outdoor temperature sensor, SIReOTX, connected to SIReA1X.	Try to reset the alarm. Check connections and cable. False errors can occur in conjunction with communication error, check that all other alarms have been reset. Measure resistance, 47kOhm at 25°C.
E20	Communication error	SIReA1X/C1X (external pc-board) do not communicate.	Try to reset the alarm. Check connections, modular cables and terminals, between all units and components. Systematically shift position of communication cables to identify a broken terminal or cables.
		Cables are not original.	Make sure communication cables are correct (Frico original cables has a circuit diagram indicating how the contacts shall be crimped on to the cable.)
E21	Room sensor error	Fault on internal room temperature sensor in SIReUA1.	Try to reset the alarm. Check connections and cable. False errors can occur in conjunction with communication error, check that all other alarms have been reset. If the error is not rectified SIReUA1 must be replaced.
E22	Multiple control units connected	Logging tool or an extra control unit SIReUA1 is connected to the system.	Try to reset the alarm. The system will only support one control unit, disconnect and reset alarm.
E23	Firmware error	Components of different releases are used in the system.	Make sure all units are from the same release, contact Frico technical support.

Connecting external control - including BMS functions

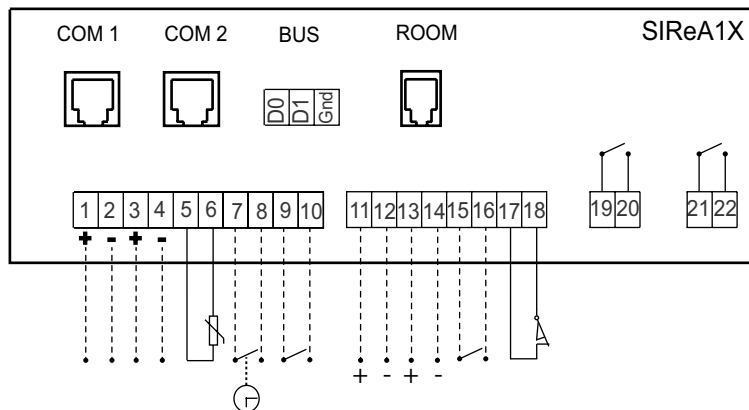

Terminal	Functions
COM1	RJ12 (6/6) SIRe internal communication
COM2	RJ12 (6/6) SIRe internal communication
D0	BUS
D1	Modbus/RTU via Rs-485.
Gnd	See separate manual: SIRe Modbus
ROOM	RJ11 (4/4) Pin 1+2 and 3+4, SIReRTX (accessory)

1+ 2-	RPM indication 0-10V DC OUT (max 5 mA). Signal from SIRe indicates 0-100 % fan speed. Always active.	13 14	External heat control 0-10V DC IN. Control heat 0-100 %. Set parameter: Installer menu > External control > 0-10V heating control = On
3+ 4-	Heat indication (Actuator control) 0-10V DC OUT (max 5 mA). Signal from SIRe indicates 0-100 % heat step. Control signal to modulating actuator. Always active.	15 16	External on/off External voltfree (dry) contact. Closes to activate system. Set parameter: Installer menu > External control > External On/Off = On
5 6	Outdoor sensor (Mandatory) SIReOTX (included).	17 18	Door contact (Mandatory) External voltfree (dry) contact. SIReDC (included) or other contact (e.g. in BMS or door automatic). Door open = Closed contact Door closed = Open contact
7 8	Setback temperature External voltfree (dry) contact. Close to activate night temperature. Always active.	19 20	BMS Alarm out Internal voltfree (dry) contact, max 3A, 230V. Always active. Indicates alarm. Closed contact = Alarm Open contact = No alarm
9 10	External alarm IN External voltfree (dry) contact. Closes to indicate an alarm. If used for filter guard, set Parameter: Installer menu > Filter guard > External filter guard = On Always active.	21 22	BMS indication OUT Internal voltfree (dry) contact, max 3A, 230V. Always active. Indicates operation. Closed contact = In operation Open contact = Not in operation
11 12	External rpm 0-10V DC IN. Control fan speed 0-100 %. Set parameter: Installer menu > External control > 0-10V Fan control = On		



Main office

Frico AB
Box 102
SE-433 22 Partille
Sweden

Tel: +46 31 336 86 00

mailbox@frico.se
www.frico.se

**For latest updated information and information
about your local contact: www.frico.se**