

Angus V

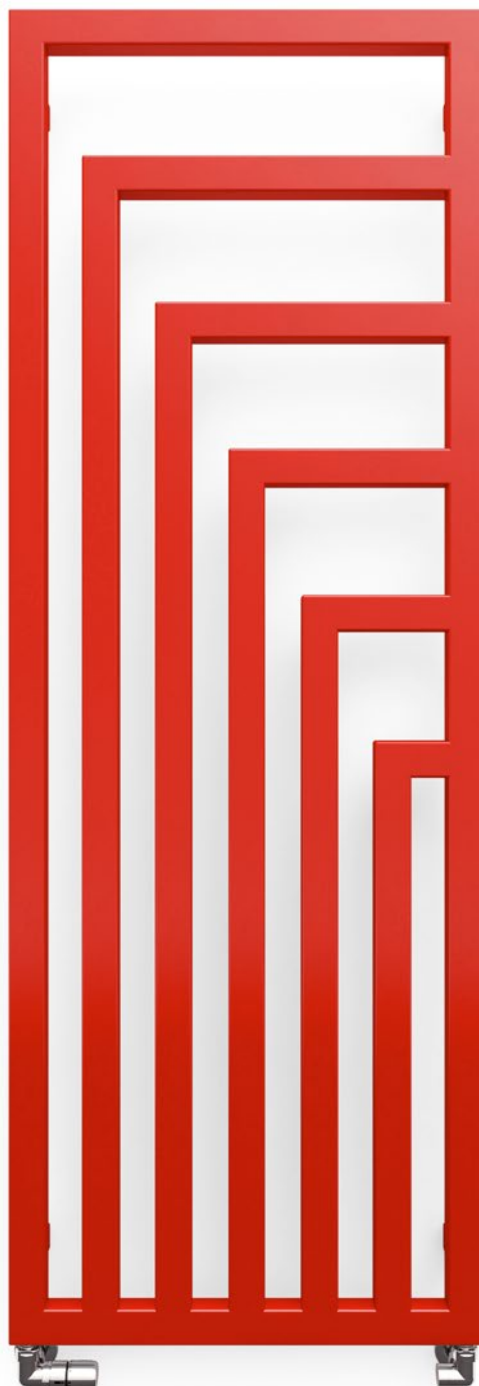

colour included
in the price



Angus V 1460↓ × 520↔ SX
colour: RAL 3020

3-axis thermostatic valve set, left, chrome
Pipe-masking set, chrome



Angus V



Design: Artes Design

Standard connection:

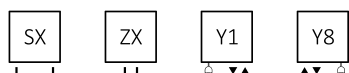

Optional connection:

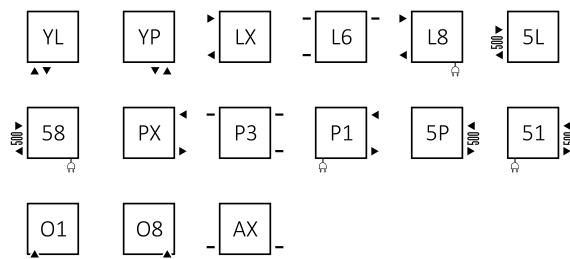

Electric radiators:

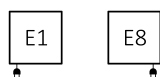

Available sizes:

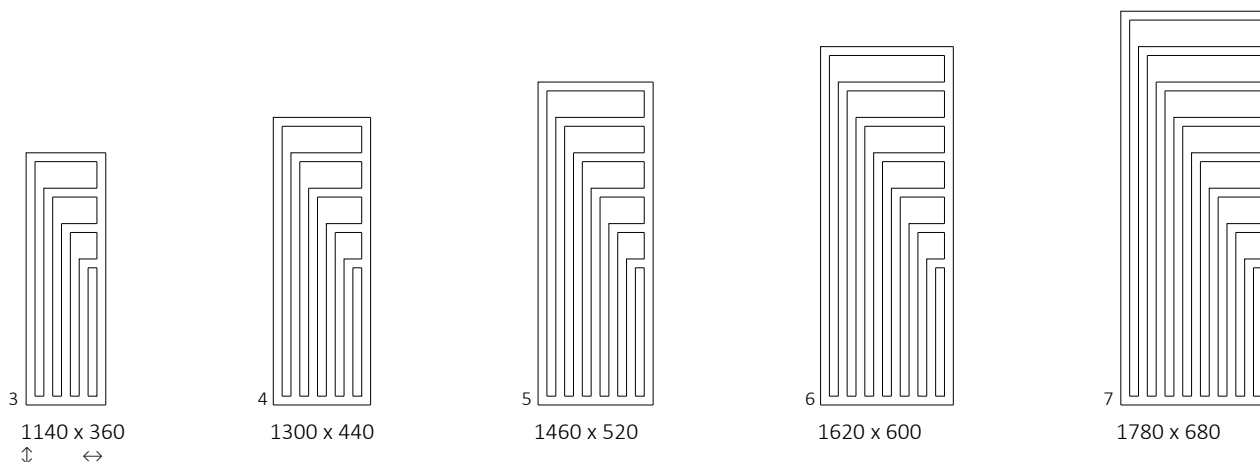

Specification:

Working pressure: 800 kPa Maximum operating temperature: 95°C

A ↓ [mm]	B ↔ [mm]	C1 [mm]	C2 [mm]	75/65/20°C [W]	55/45/20°C [W]	☺ [W]	D [mm]	E [mm]	F [mm]	U [dm³]	W [kg]	Product code <small>Configuration code p. 6</small>
1140	360	50	320	421	224	400	320	960	90	5,18	11,50	WGANG114036
1300	440	50	400	557	293	600	400	1120	90	6,92	15,36	WGANG130044
1460	520	50	480	711	372	800	480	1280	90	8,88	19,71	WGANG146052
1620	600	50	560	905	472	1000	560	1440	90	11,07	24,57	WGANG162060
1780	680	50	640	1116	580	1200	640	1600	90	13,48	29,92	WGANG178068



colour included
in the price

Technical drawing:

SX

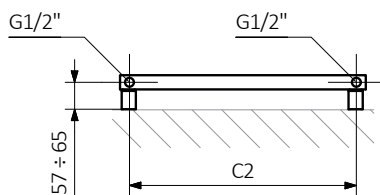

ZX

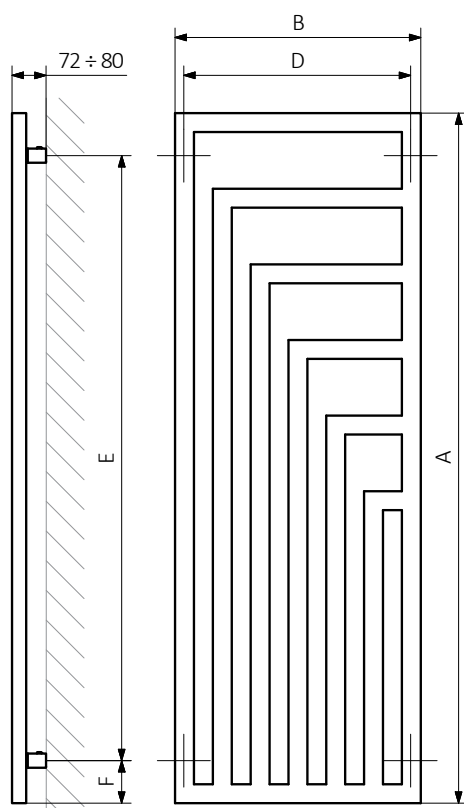
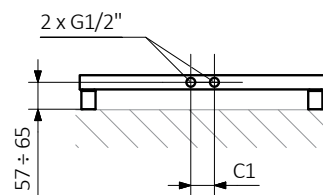

Y1

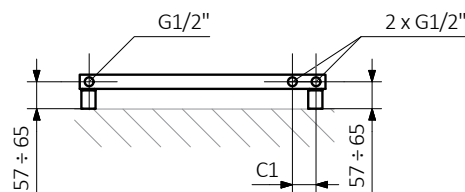

Y8

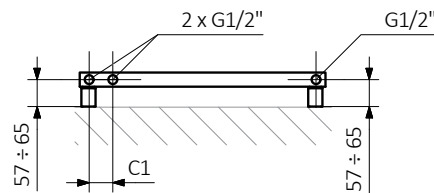

A – Height B – Width C1-C5 – Distance between pipe centres D – Horizontal distance between mounting bracket centres
E – Vertical distance between mounting brackets F – Distance between a mounting bracket and the bottom of the radiator

Pipe:

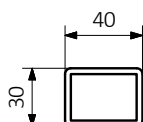



colour included
in the price

Technical drawing:

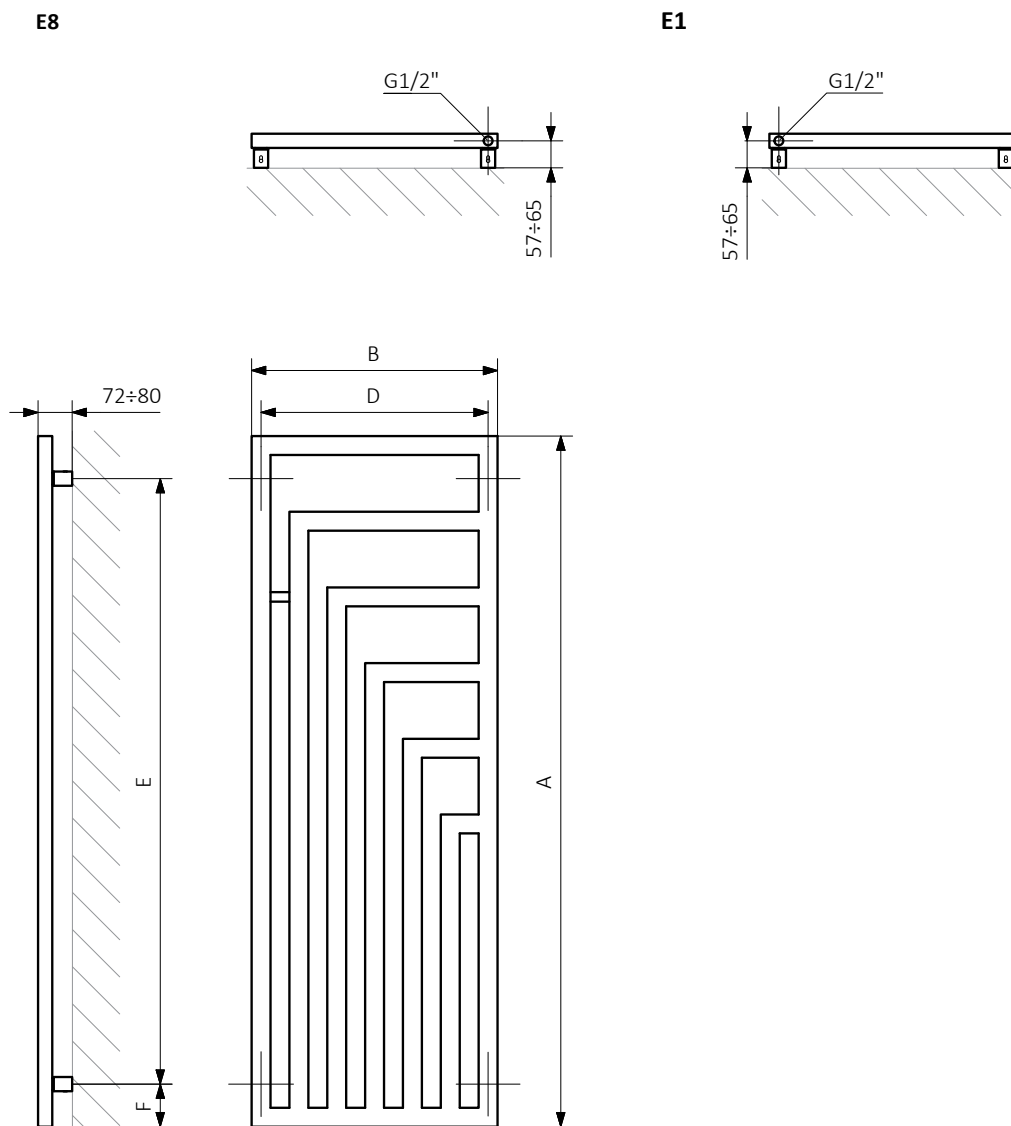

A – Height B – Width C1-C5 – Distance between pipe centres D – Horizontal distance between mounting bracket centres
E – Vertical distance between mounting brackets F – Distance between a mounting bracket and the bottom of the radiator

Pipe:

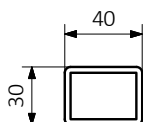



In the table with technical data, the last column lists product codes. When placing an order, please remember to quote the product code followed by the configuration code as shown in the diagram below:

The construction of a water and dual fuel radiator product and configuration code

WGANG114036

K916SX

PRODUCT CODE
(located in the table for the product)

CONFIGURATION CODE
(supplemented by hand)

Example Configuration

K 916 SX

Package code Colour code Connection code
K - carton box

Construction of electric heater configuration code:

WLANG114036

K916E1DRYM

PRODUCT CODE
(located in the table for the product)

CONFIGURATION CODE
(supplemented by hand)

Example Configuration

K 916 E1 DRY M

Package code Colour code Connection code Heating element code Type of heating element cable code
K - carton box

Epoxy primer

E – Code of epoxy primer is an extra processes.

WGANG114036 K916SX **E** — *Extraprocessesoradditionscode*

Angus V



 colour included
in the price

Legend



Radiator available in a "water" version.



Radiator suitable for dual fuel connection. Electric heating element can be installed.



Radiator available in electric only version. It comes prefilled with a 'heating medium' and equipped with a heating element. All tested and ready to use.



Connection types dedicated for this radiator. The icon shows the flow and return connections for the radiator as well as the thermostatic valve and heating element position if applicable.



Suggested heating element power output for electric and dual fuel versions.



Weight.



Capacity.



Available in chrome finish.



No additional payment for a color.